

ERECTED 1888.  
 TYPE FRAME  
 FOUNDATION PILE HEADS  
 WALLS 2"x6"  
 ROOF { TYPE GABLE, SHINGLE  
       PITCH 1/3  
 HEATING STOVES

FLOOR 7/8"x3 1/4"  
 FINISH { INSIDE 7/8"x5 1/2" M+B.  
        OUTSIDE BOXING & DATTEMS.  
 CEILING HEIGHT 12'-6" FRT. 10'-11"  
 LIGHTING LAMPS.  
 SANITARY FACILITIES OUTSIDE.

EASTERN P.V.  
 CLINTON SUB  
 STA. No. D186

59

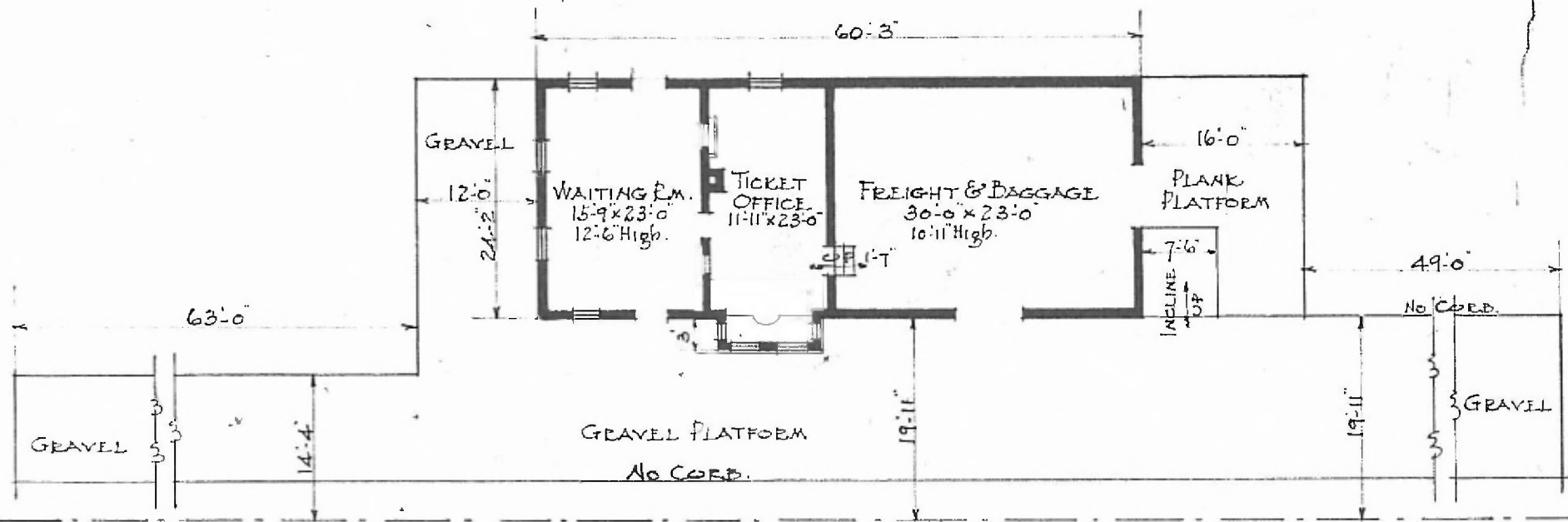

FLOOR PLAN  
 SCALE 1/16" = 1'-0"



COMBINATION STATION  
 WILLARD, MO.

JAN 4. 1916