

72

MISSOURI E. NORTH ARKANSAS R.R.

DIV. CENTRAL
SUB. DIV. FT. SMITH
STA. NO 304

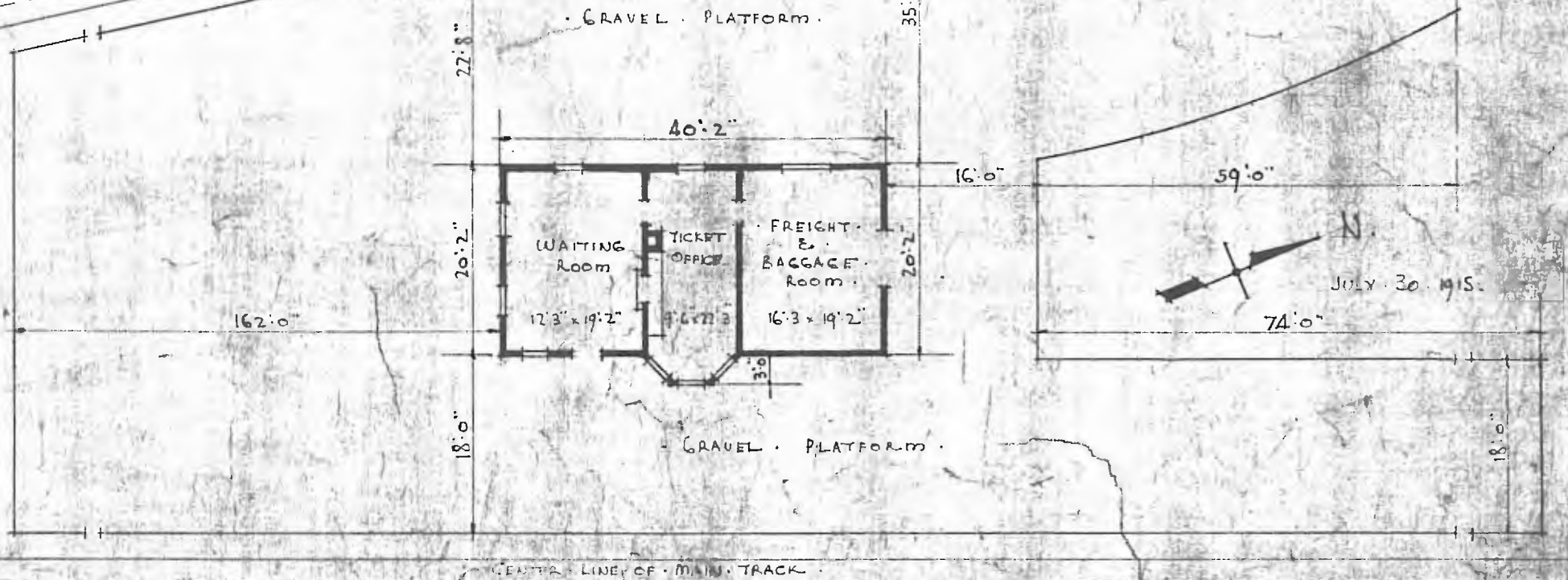

ERECTED 1913.
 TYPE FRAME.
 FOUNDATION CONCRETE.
 WALLS 2"x4" STUDS.

ROOF	{ TYPE	HIP - SHINGLES.
	{ PITCH	APPROX. 3/4 PITCH.
HEATING		STOVES.
FLOOR		2 1/2" MAPLE.
FINISH	{ INSIDE	3/4" x 3/4" V. JOINT. CEILING.
	{ OUTSIDE	1" x 6" & DROP SIDING.
CEILING HEIGHTS		11'5"
LIGHTING		OL. LAMP.
SANITARY FACILITIES		OUTSIDE TOILETS.

COMBINATION STATION AT
WAYNE - MO.