

4

ERECTED, 1904.  
 TYPE FRAME  
 FOUNDATION, PILE HEADS.  
 WALLS, 2"x0"  
 ROOF TYPE, GABLE, SHINGLES  
 L.P. ROW  
 HEATING, STOVES

WINDOW 2' x 4' 6" FINES  
 INSIDE 2' x 0' 1" D. CEILING  
 FINISH  
 OUTSIDE, BOARD & BATTS.  
 CEILING HEIGHT 8' 11" FEET, RM. 13' 2"  
 LIGHTING, LAMPS.  
 SANITARY FACILITIES, OUTSIDE TOILETS.

DIV. CENTRAL  
 STA. WASHBURN  
 STA. NO. 307  
 SUB. DIV. FT. SMITH

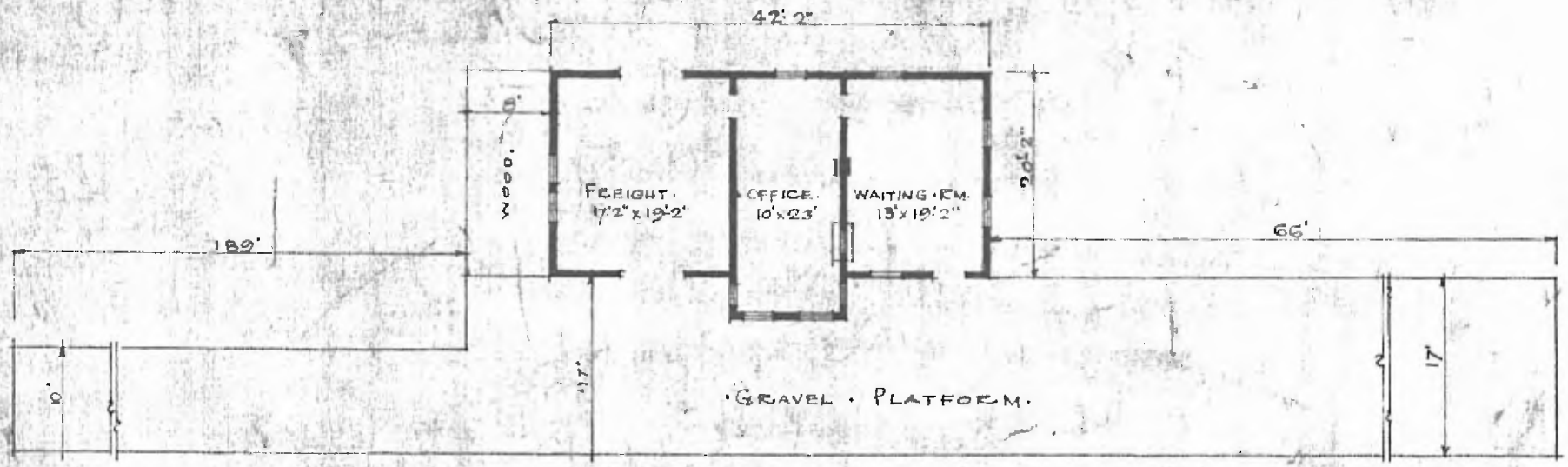

FLOOR PLAN.  
 SCALE  $\frac{1}{16}'' = 1'-0''$



COMBINATION STATION AT  
 WASHBURN, MO.

July 28, 1915.