

ERECTED 1884
 TYPE FRAME
 FOUNDATION PILE HEADS
 WALLS 2" x 6"
 ROOF { TYPE - GABLE - SHINGLES
 PITCH - 1/3
 HEATING STOVES

FLOOR 3/4" x 3/4" Y. PINE
 FINISH { INSIDE
 { OUTSIDE
 CEILING HEIGHT 13'-4"
 LIGHTING OIL LAMPS.
 SANITARY FACILITIES. OUTSIDE TOILETS.

DIV. EASTERN
 SUB. DIV. CLINTON
 STA. No. 173 99

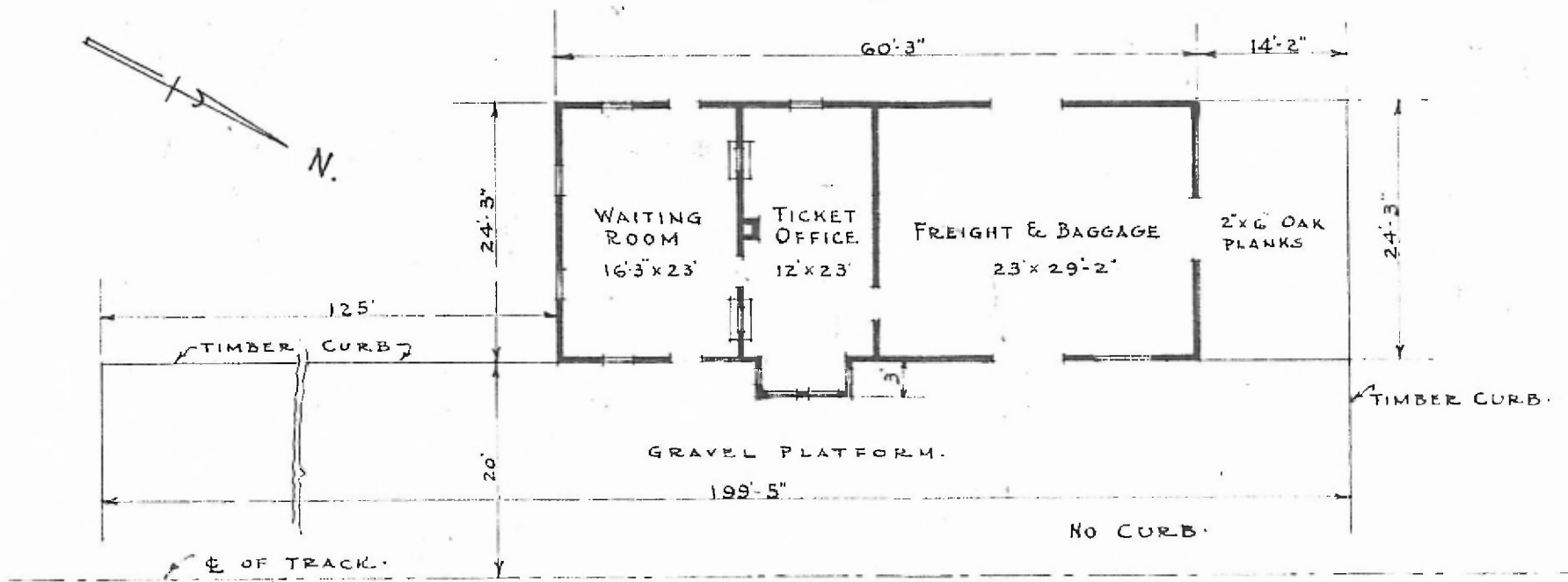

FLOOR PLAN.
 SCALE: 1/16" = 1'-0"

PASSENGER STATION AT
 WALNUT GROVE MO.