

| | | | |
|---------------|-----------------|----------------------|---|
| ERECTED. | 1912. | FLOOR. | 2 1/4" MAPLE. |
| TYPE. | FRAME. | FINISH { INSIDE. | 3/4" x 3/4" V. JOINT. CEILING. |
| | | | DROP SIDING. |
| FOUNDATION. | CONCRETE. | CEILING HEIGHTS. | 11' 4" WAITING ROOMS; T.O.; F.E.B. ROOMS. |
| WALLS. | 2x6 STUDS. | LIGHTING. | OIL LAMPS. |
| ROOF. { TYPE. | HIP - SHINGLES. | SANITARY FACILITIES. | OUTSIDE TOILETS. |
| | PITCH. | | |
| HEATING. | STOVES. | | |

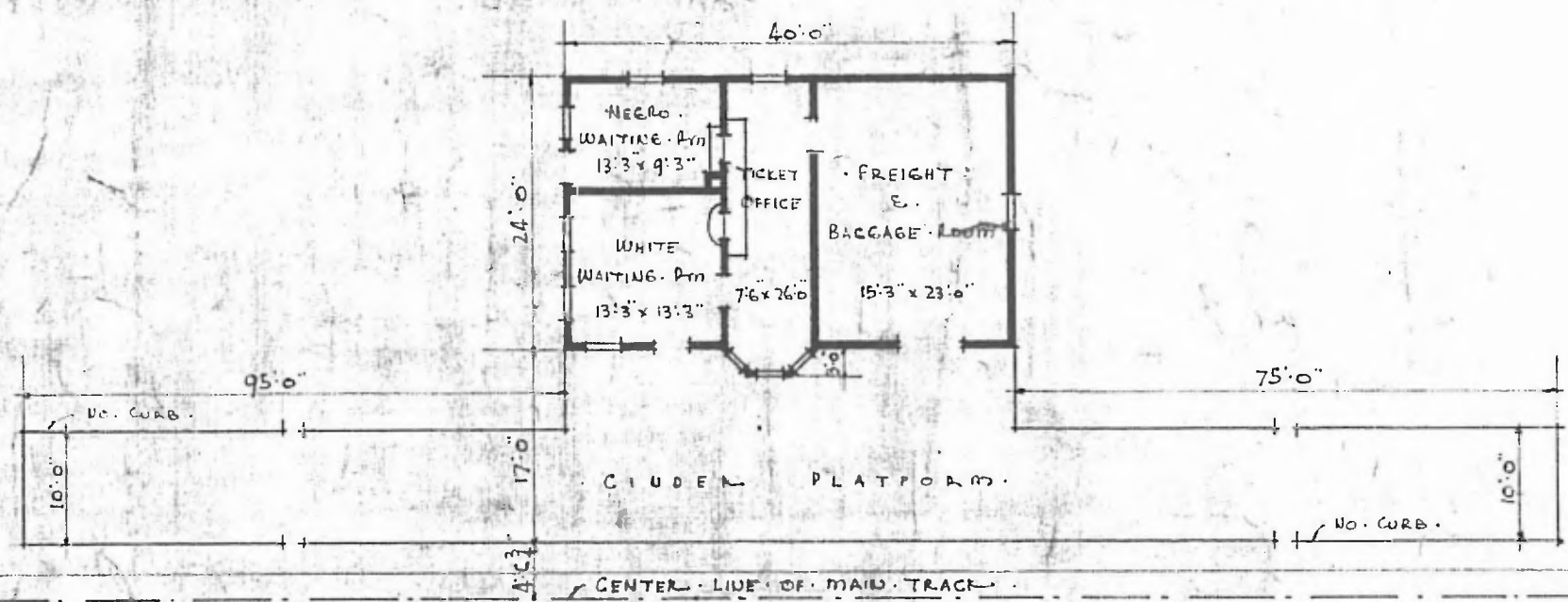

FLOOR PLAN
SCALE 1/16" = 1'0"

DIV. P & GN CENTRAL DIV.
SUB. DIV. FT. SMITH ARTHUR
STA. No 583
7

N. 
JULY 9 1915.

COMBINATION STATION AT
POWDERLY - TEXAS