

ERECTED 1901  
 TYPE FRAME  
 FOUNDATION PILE HEADS  
 WALLS 2x6  
 ROOF { TYPE GABLE-SHINGLES  
 PITCH  $\frac{1}{3}$   
 HEATING STOVES

FLOOR I"  $\frac{1}{8}$  x 34"  
 $\frac{1}{8}$  x 34" M. & B.  
 FINISH { INSIDE B. & B. DROP SIDING  
 OUTSIDE  
 CEILING HEIGHT WAIT. ROOM = 12'-0" FRT. RM. = 10'-9" OPEN  
 LIGHTING OIL  
 SANITARY FACILITIES OUTSIDE TOILETS

St. 695  
 Sub F2 worth  
 Div. Std., S.S. & T. (5)

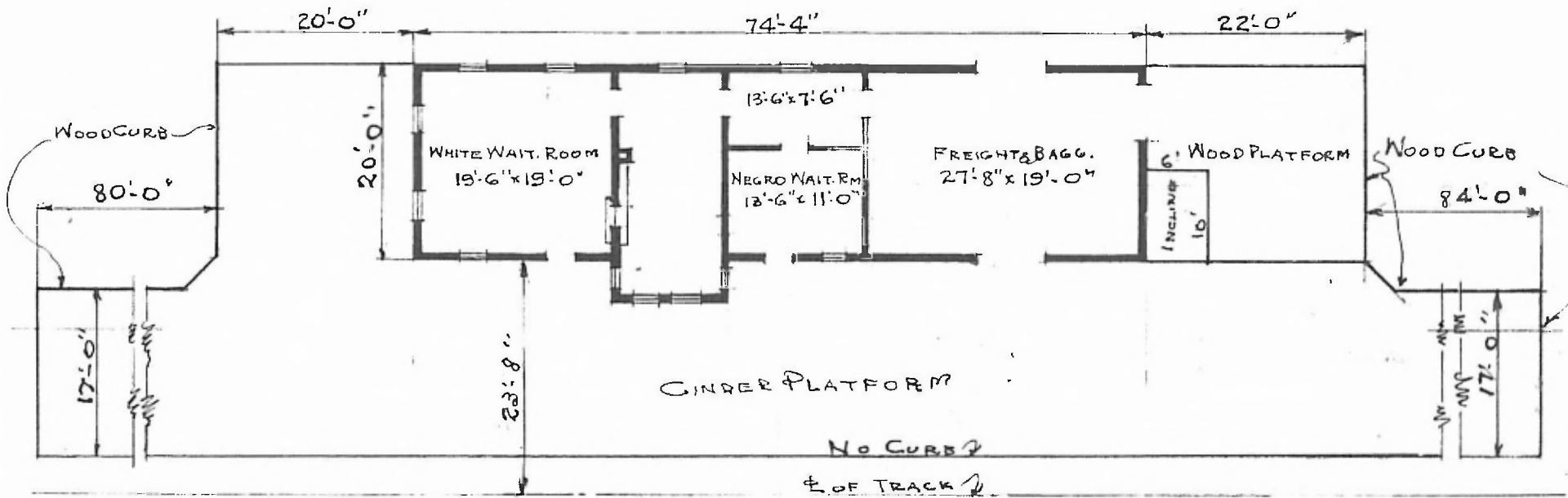

FLOOR PLAN  
 SCALE:  $\frac{1}{16}$ " = 1'-0"



COMBINATION STATION  
 HEBRON, TEX.

2/23/1920