

8

ERECTED 1900  
 TYPE FRAME  
 FOUNDATION PILE HEADS  
 WALLS 2x6  
 ROOF { TYPE GABLE-SHINGLES  
 PITCH 3  
 HEATING STOVES

FLOOR 7"  
8" 3/4"  
8" 3/4" M. & B.  
 FINISH { INSIDE  
 OUTSIDE BOX & BATT. DROP SIDING  
 CEILING HEIGHT WAIT. ROOM = 14'2"; FREIGHT ROOM = 13'0" OPEN  
 LIGHTING ELECTRIC  
 SANITARY FACILITIES OUTSIDE TOILETS

St. 686  
 Sub. Fr. West  
 Div. St. d., S.F.A.

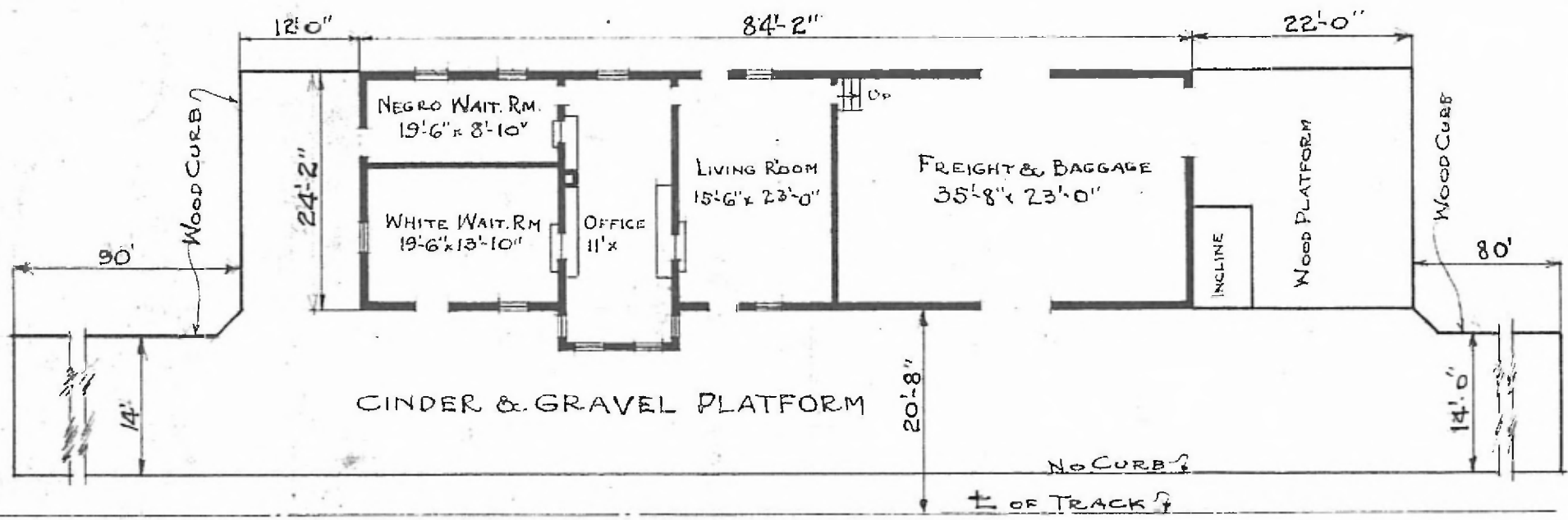

FLOOR PLAN  
 SCALE: 1/16" = 1'-0"



COMBINATION STATION  
 FRISCO, TEX.

FEB. 19, 1920