

ERECTED 1904  
 TYPE BRICK  
 FOUNDATION CONCRETE  
 WALLS 13" BRICK  
 ROOF { TYPE HIP-TILE  
 PITCH  $\frac{1}{3}$   
 HEATING ST

FLOOR CONCRETE  
 FINISH { INSIDE  $\frac{3}{8}$ " x  $\frac{1}{2}$ " WOOD WAINSCOT  
 OUTSIDE BRICK  
 CEILING HEIGHT 12'-0"  
 LIGHTING ELECTRIC  
 SANITARY FACILITIES OUTSIDE TOILETS

St 576  
 R. V. 1/24  
 (15)  
 Rio Grande  
 Railway

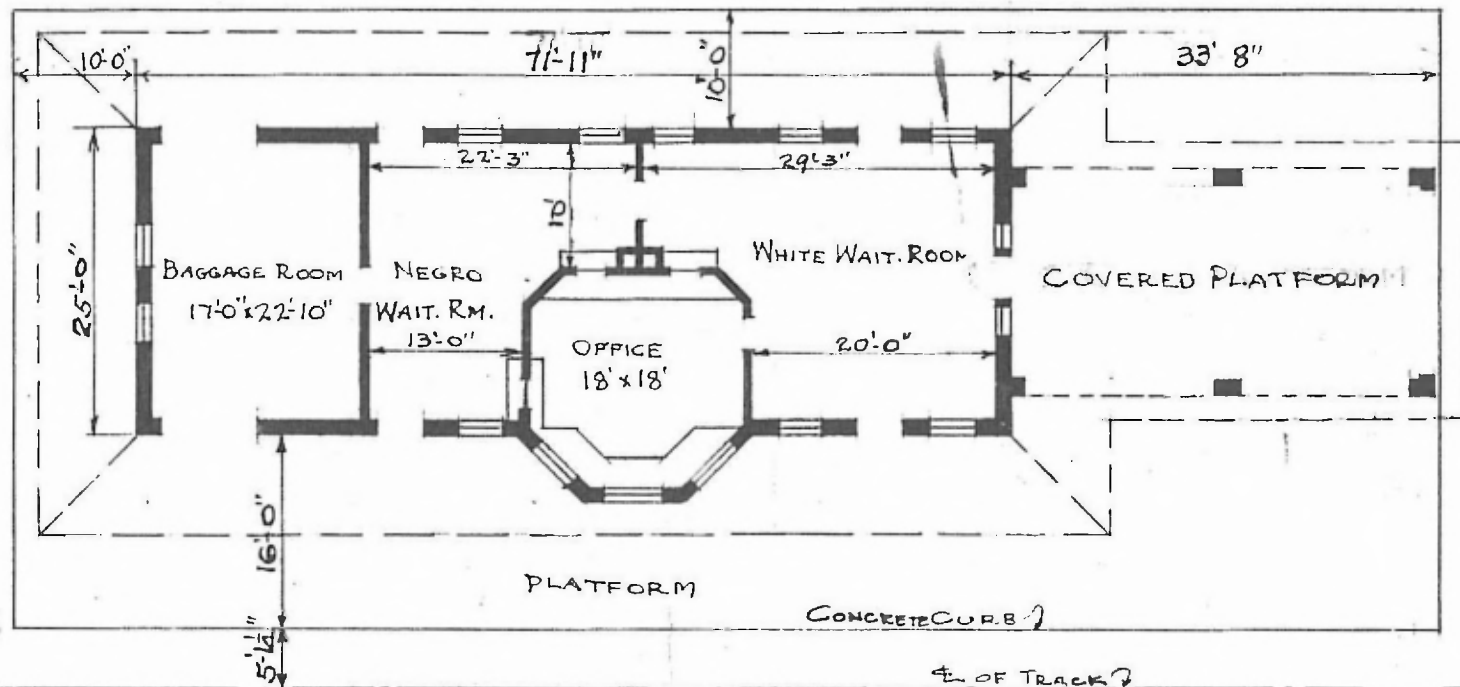

FLOOR PLAN  
 SCALE:  $\frac{1}{16}$ " = 1'-0"

PASSENGER STATION  
 BROWNWOOD, TEX.