

ERECTED 1884
 TYPE FRAME
 FOUNDATION PILE HEADS.
 WALLS 2"x6"
 ROOF { TYPE GABLE SHINGLE,
 FITCH 1/3
 HEATING STOVES.

FLOOR 7/8"x32"
 FINISH { INSIDE 7/8"x32" BEADED.
 OUTSIDE BOARDS & PATTERNS.
 CEILING HEIGHT 12'-0"
 LIGHTING LAMPS;
 SANITARY FACILITIES. OUTSIDE

EASTERN DIV.
 LEADMAN SUB
 STA. No. 152

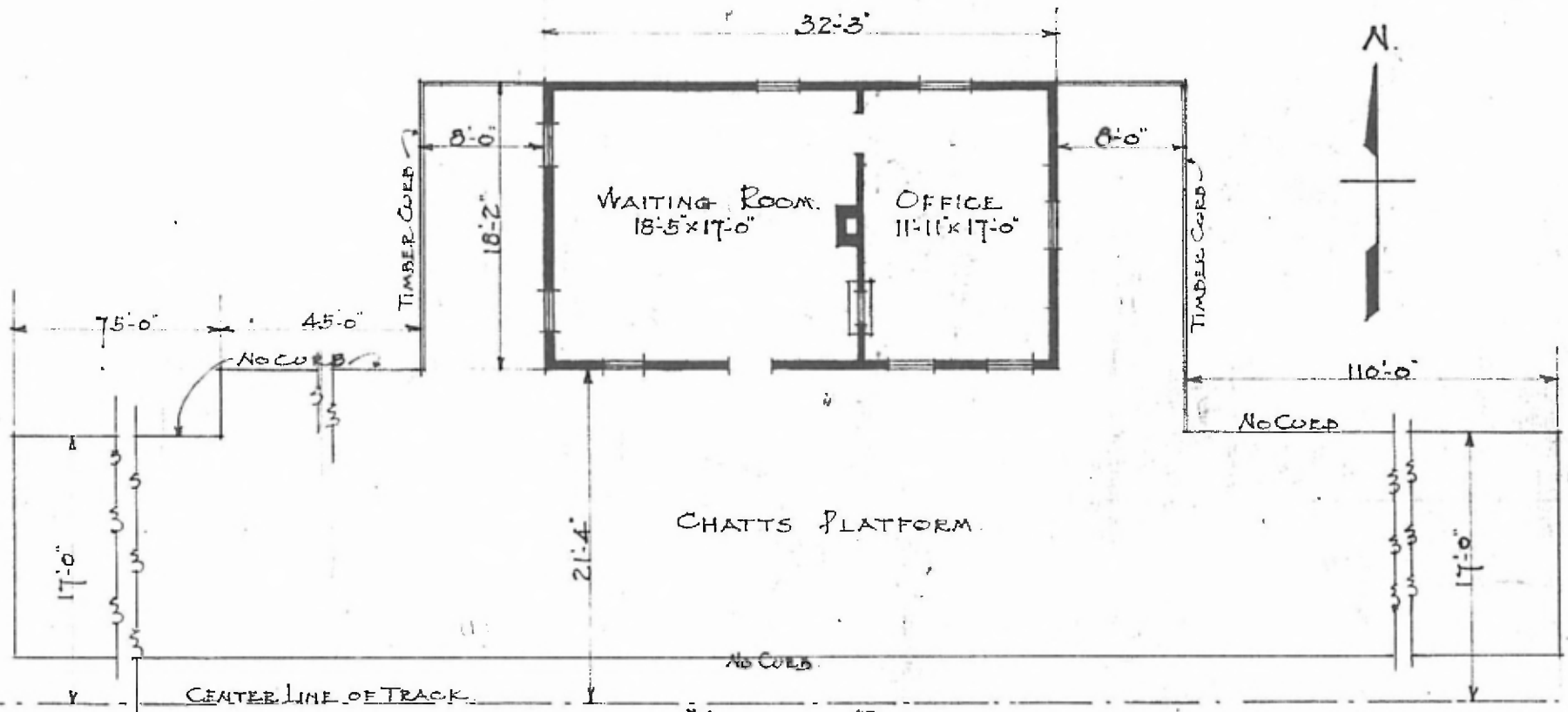

FLOOR PLAN.
 SCALE 3/32" = 1'-0"

COMBINATION STATION
 SWEDENBORG, MO.

DEC. 26 1916.