

ERECTED 1880
 TYPE FRAME
 FOUNDATION PILE HEADS
 WALLS 2" x 6"
 ROOF { TYPE - GABLE - SHINGLES
 PITCH - 1/3
 HEATING STOVES

FLOOR 7/8" x 3 1/4"
 FINISH { INSIDE 7/8" x 3 1/4" DD. CEILING
 OUTSIDE BOX & BATTENS
 CEILING HEIGHT 13'-2 1/2"
 LIGHTING LAMPS
 SANITARY FACILITIES - OUTSIDE TOILETS

EASTERN DIV.
 ROLL'G SUP' B
 STA. No. 68

27

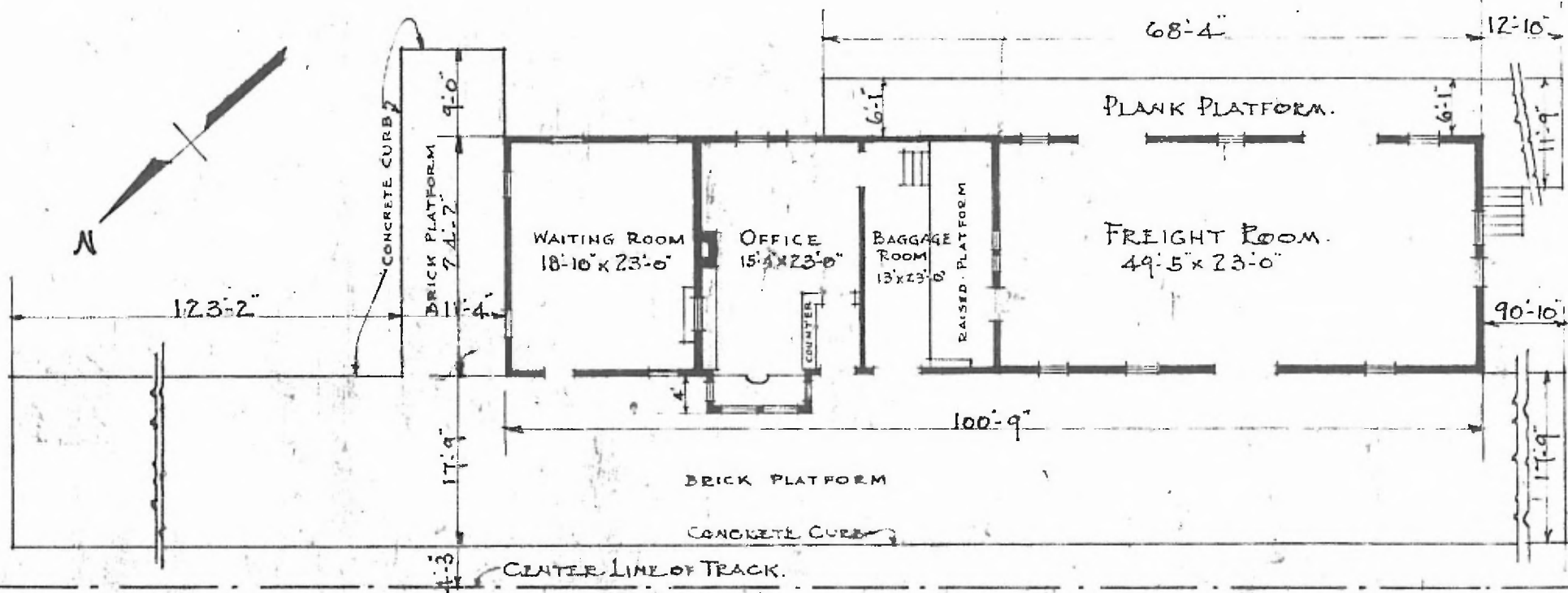

FLOOR PLAN
 SCALE: 1/16" = 1'-0"

PASSENGER STATION AT
 SULLIVAN MO.

JAN. 17, 1917.