

ERECTED 1922.
 TYPE FRAME.
 FOUNDATION PILE HEADS.
 WALLS 2" x 6"
 ROOF { TYPE GABLE DROP SIDING.
 { PITCH 1/3 PRÉP. ROOFING
 HEATING STOVES.

FLOOR YR & PLANK 1/8" & 2" SHIPLAP.
 FINISH { INSIDE BOARD CEILING.
 { OUTSIDE.
 CEILING HEIGHT 12'-0"
 LIGHTING
 SANITARY FACILITIES OUTSIDE.

EASTERN DIV.
 ROLL'D 5013
 STA. NO. 52

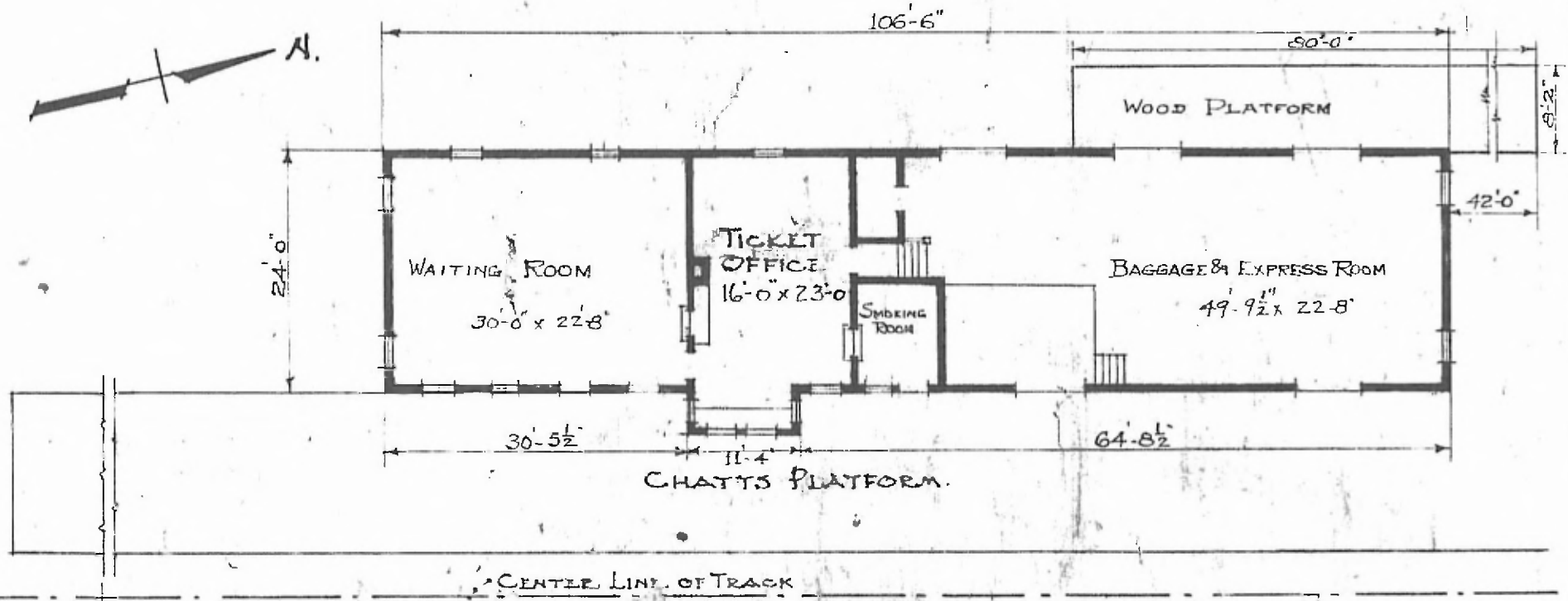

FLOOR PLAN.
 SCALE: 1/16" = 1'-0"

PASSENGER STATION AT
 ST. CLAIR, MO.

REVISED OCT. 5, 1921
 JAN. 11, 1917.