

ELECTED 1864
TYPE BRICK
FOUNDATION STONE
WALLS BRICK 13"
ROOF { TYPE GABLE SHINGLE.
PITCH 1/4
HEATING STOVES

FLOOR 3/8 x 3 1/2 PINE & CONCRETE. STA. No. 111
FINISH { INSIDE PLASTER
OUTSIDE BRICK, PAINTED.
CEILING HEIGHT 15'-2" FET 12'-7"
LIGHTING ELECTRIC 2 WIRE 220 VOLTS
SANITARY FACILITIES INSIDE TOILETS

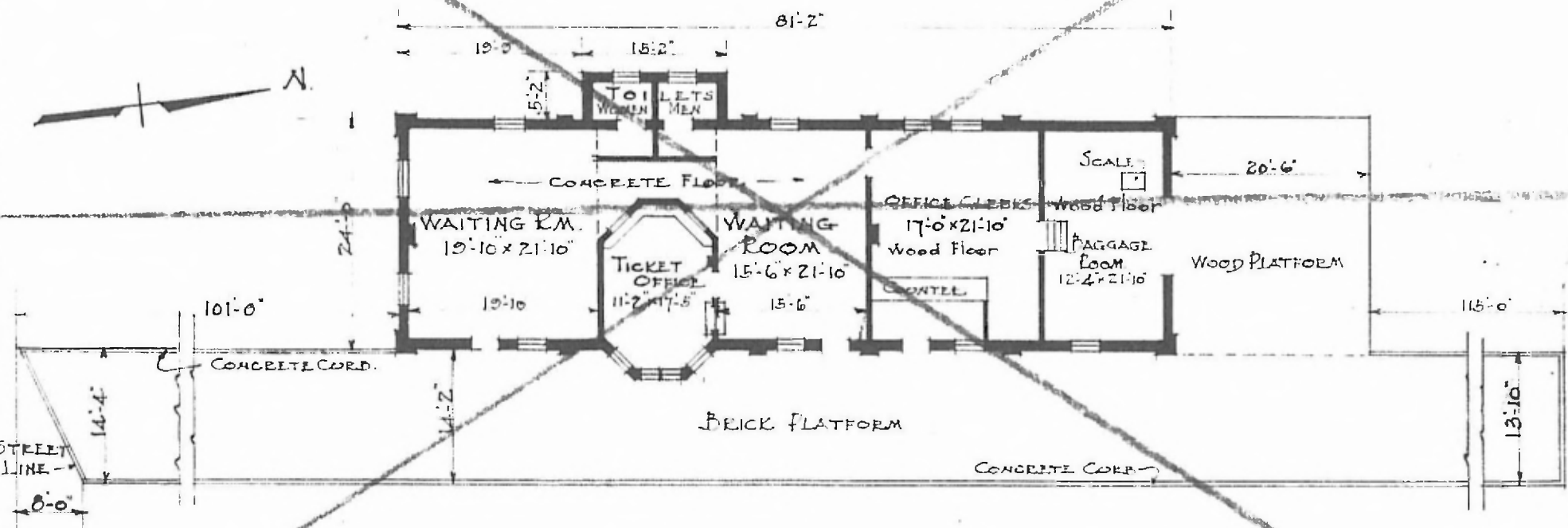

FLOOR PLAN.
SCALE 1/16" = 1'-0"

VOID.
SEE NEW DRAWING.

PASSENGER STATION.
ROLLA, MO.

AUG. 1, 1916