

ERECTED 1915.
 TYPE. FRAME.
 FOUNDATION CONCRETE.
 WALLS 2"x6"
 ROOF { TYPE. HIP. SHINGLE.
 PITCH 9 1/2 PER FT.
 HEATING STOVES.

FLOOR 7/8"x3 1/4" PINE.
 FINISH { INSIDE 3/8"x3 1/4" V. JOINT.
 OUTSIDE. DROP SIDING.
 CEILING HEIGHT. 11'-6"
 LIGHTING LAMPS.
 SANITARY FACILITIES. OUTSIDE.

EASTERN DIV.
 ROLL'G SUB
 STATION #1

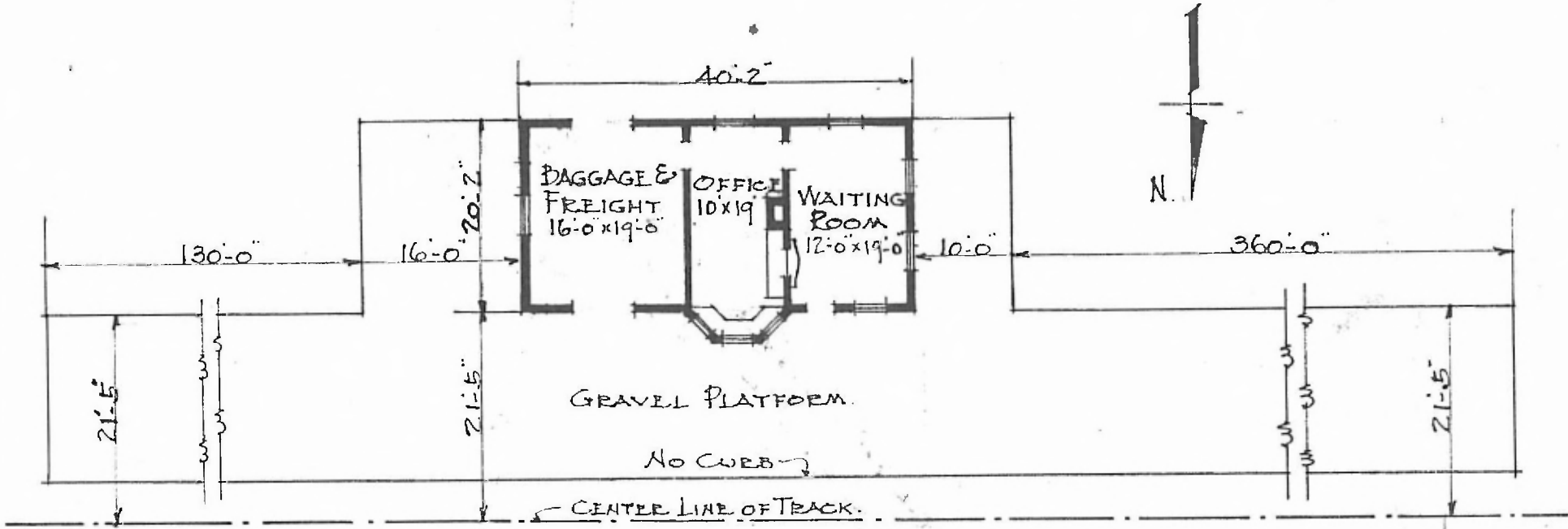

FLOOR PLAN.
 SCALE 1/16" = 1'-0"