

32

ERECTED 1872  
 TYPE FRAME.  
 FOUNDATION PILE HEADS.  
 ROOF { TYPE GABLE SHINGLE.  
       PITCH  $\frac{1}{3}$   
 WALLS 2x6.  
 HEATING STOVES.

FLOOR  $\frac{3}{4} \times 3\frac{1}{4}$  Y PINE.  
 FINISH { INSIDE  $\frac{3}{4} \times 3\frac{1}{4}$  B.D. CEILING.  
        { OUTSIDE BOARDS AND BATTIS.  
 CEILING HEIGHT 11'-11" FRT 11'-7"  
 LIGHTING OIL LAMPS.  
 SANITARY FACILITIES OUTSIDE.

SOUTH E ST. RAILWAY  
 CHERRYVILLE ST. 3  
 STA. No. 6297

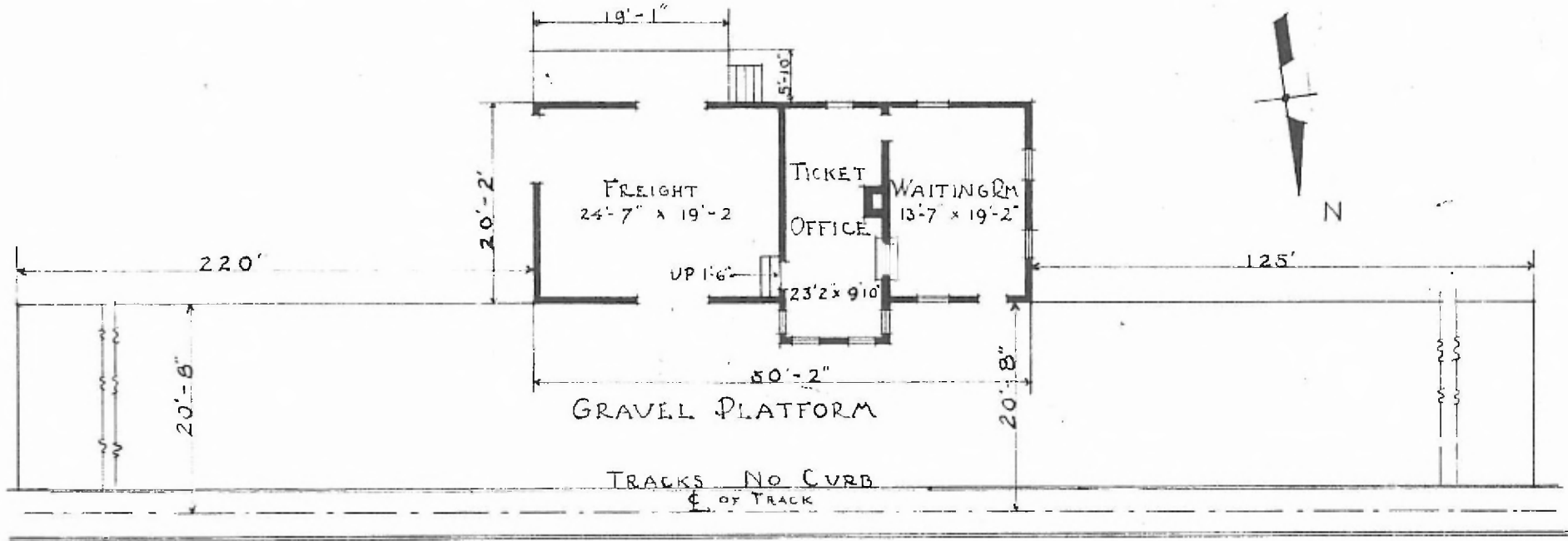

FLOOR PLAN.  
 SCALE  $\frac{1}{16}'' = 1'-0''$

PASSENGER STATION AT  
 RITCHEY, MO.

AUGUST, 15, 1916.