

34

ERECTED TYPE
FOUNDATION WALLS
ROOF { TYPE
PITCH
HEATING

1902 FRAME
PILE HEADS 2x6
GABLE-3PLY PREPARED ROOF.
STOVES

FLOOR FINISH { INSIDE
OUTSIDE
CEILING HEIGHT
LIGHTING
SANITARY FACILITIES.

$\frac{3}{4} \times \frac{3}{4}$ " Y.P.
 $\frac{3}{4} \times \frac{3}{8}$ " BEEDED
BOARDS & BATT. - 1" x 6" DROP SIDING
WAITING RM. = 14'-7". FREIGHT RM. = 15'-7"
ELECTRIC
OUTSIDE TOILETS.

RIVER DIV.
CHAFFEE SUB
STA. NO. T199

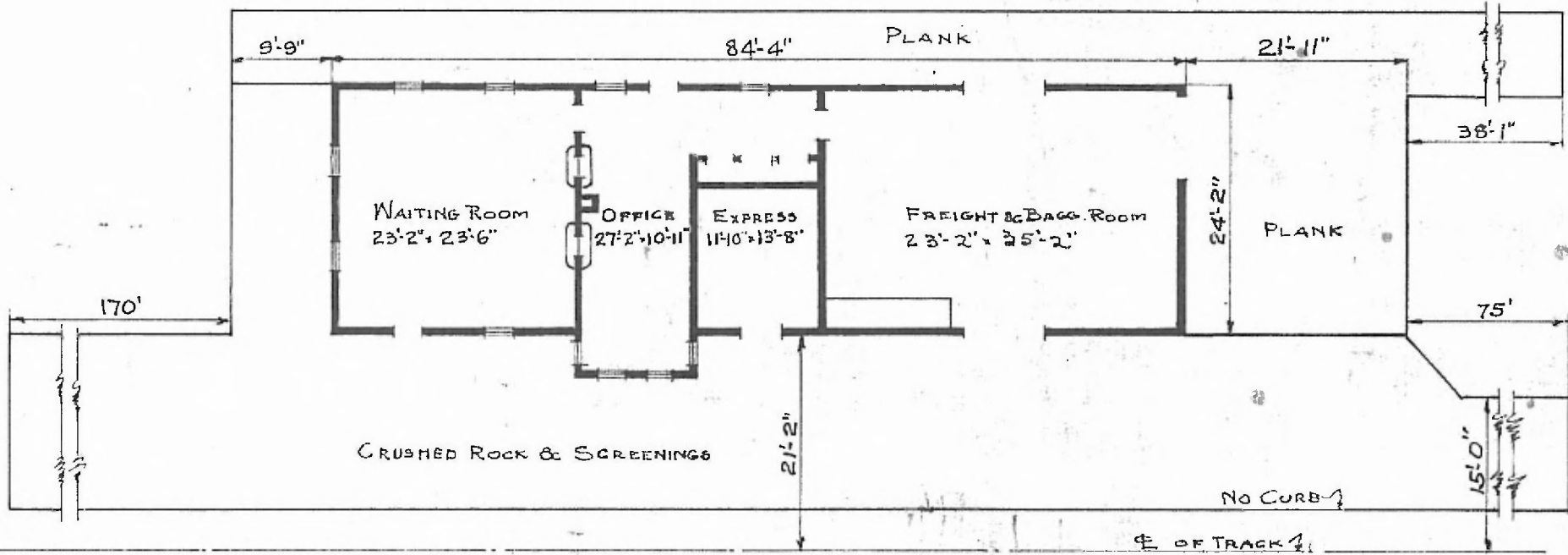

CRUSHED ROCK & SCREENINGS

NO CURB

☉ OF TRACK



FLOOR PLAN
SCALE: $\frac{1}{16}'' = 1'-0''$

COMBINATION STATION
PORTAGEVILLE, MO.

SEP. 6, 1918.