

14

ERECTED TYPE STANDARD
 FOUNDATION 10x12 POSTS
 WALLS STANDARD
 ROOF { TYPE " PITCH "
 HEATING STOVES

FLOOR FINISH { INSIDE 2 1/4" MAPLE
 { OUTSIDE 3/4" x 3/4" BEEDED
 CEILING HEIGHT STANDARD
 LIGHTING OIL LAMPS
 SANITARY FACILITIES OUTSIDE TOILET

RIVER DIV.
 ST. LOUIS SUB
 ST. No. 776

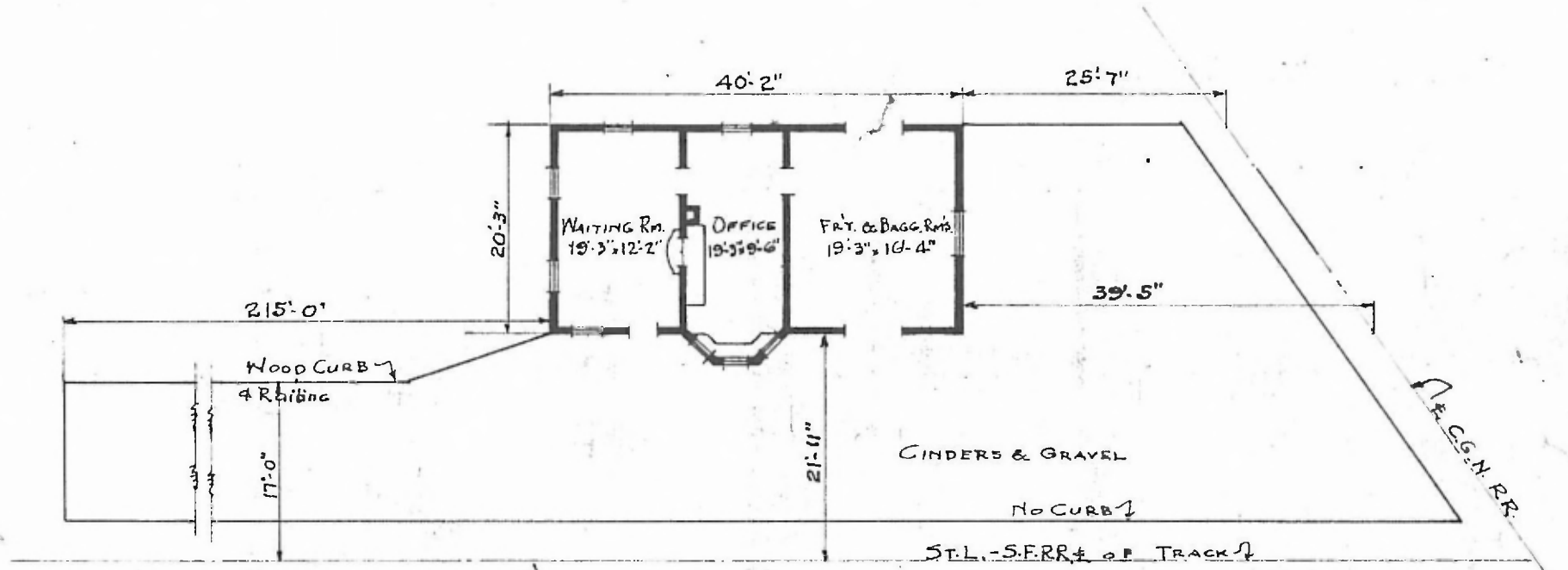

FLOOR PLAN
 SCALE: - 1/16" = 1'

COMBINATION STATION
 PERRYVILLE JCT., MO.

Aug. 3, 1917