

ERECTED  
TYPE  
FOUNDATION  
WALLS  
ROOF { TYPE  
PITCH  
HEATING

1902  
STONE  
STONE  
18" STONE  
HIP. TILE  
1/2  
STOVES

FLOOR

FINISH { INSIDE  
OUTSIDE

CEILING HEIGHT

LIGHTING

SANITARY FACILITIES OUTSIDE TOILETS

3" x 3 1/4" Y.F.  
PLASTER

STONE

10' 0"

ELECTRIC

EASTERN ATTY  
ROLLA SUB  
STA. No. 717

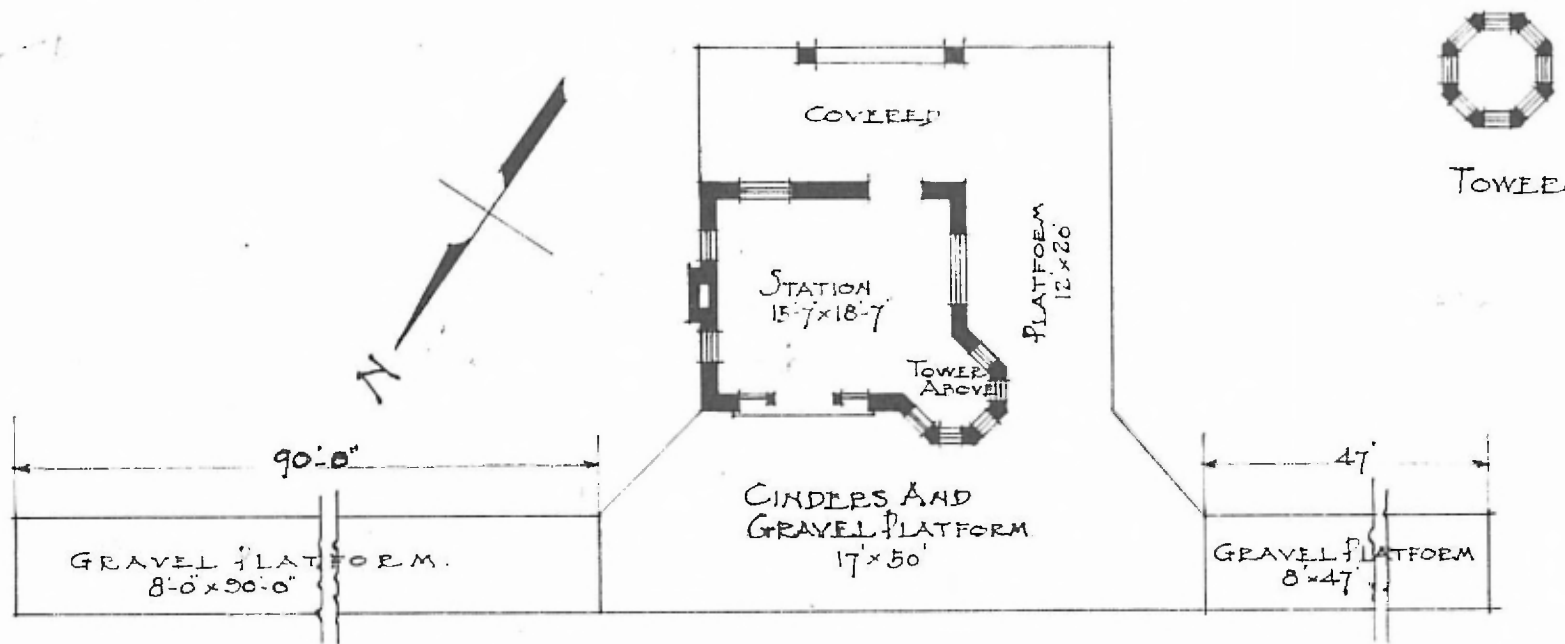

FLOOR PLAN  
SCALE 1/8" = 1'-0"

PASSENGER STATION  
LINDENWOOD, MO.

FEB. 7. 1917.