

78

ERECTED 1885
 TYPE FRAME
 FOUNDATION PILE HEADS
 WALLS 2x6"
 ROOF { TYPE GABLE-SHINGLES
 PITCH 1/3
 HEATING STOVES

FLOOR 7/8x3 1/2
 FINISH { INSIDE 7/8x3 1/2 M. & B.
 OUTSIDE BOV. & BATTENS
 CEILING HEIGHT WAIT. RM. 12'-4" - BAGG. RM. 12'-10"
 LIGHTING OIL
 SANITARY FACILITIES OUTSIDE TOILETS

SOUTHERN DIV
 WILLOW SPRING SUB
 STA No. 5-269

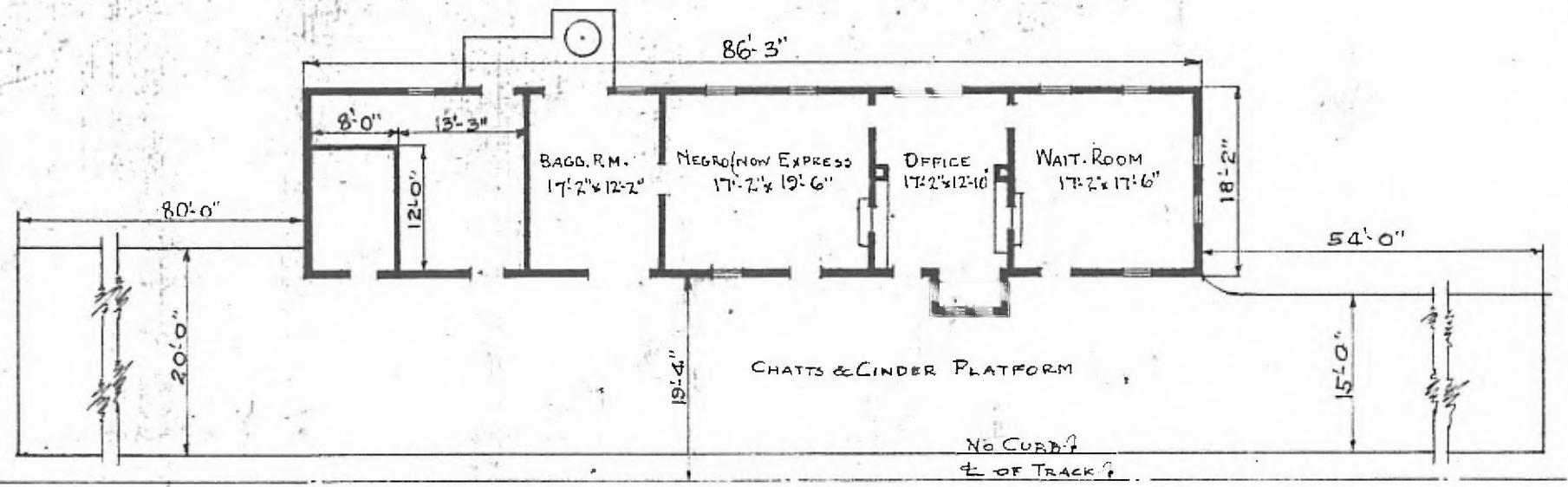

FLOOR PLAN
 SCALE: 1/16" = 1'-0"

PASSENGER STATION
 HUNTER, MO.

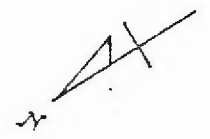

Aug. 20, 1919