

6

ERECTED
 TYPE
 FOUNDATION
 WALLS
 ROOF { TYPE
 PITCH
 HEATING

FRAME
 PILE HEADS
 2x6
 GABLE - SHINGLES
 1/3
 STOVES

FLOOR
 FINISH { INSIDE
 OUTSIDE
 CEILING HEIGHT
 LIGHTING
 SANITARY FACILITIES

1' 1/8" x 3/4"
 3/4" x 3/4" M. & B.
 Box. & Batt. - 7/8" x 3 1/2" D. S.
 WAITING RM. - 11'-6", FR'T. RM. 10'-0"
 OIL
 OUTSIDE TOILETS.

RIVER DIV. SUB
 ST. LOUIS
 STA. No. T35

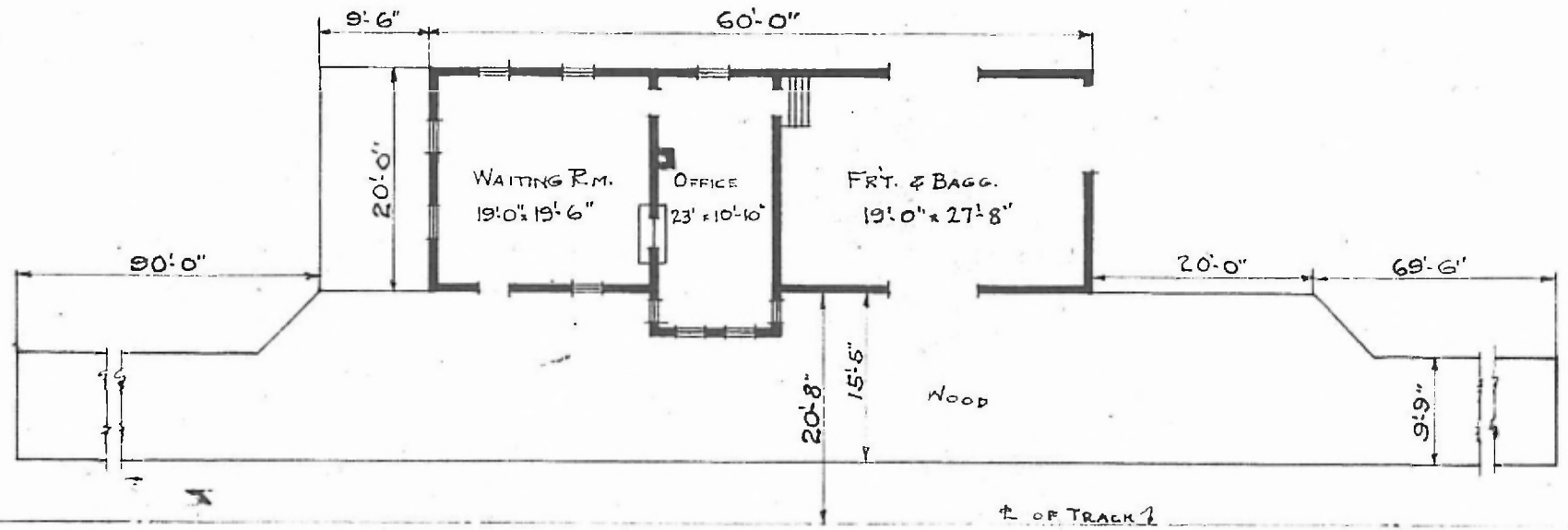

FLOOR PLAN
 SCALE: 1/16" = 1'-0"



COMBINATION STATION
 HORINE, MO.

MARCH 8TH, 1918