

68

NORTHERN DIV.
A 514. GROVE SUB
STATION BA 168

ERECTED 1891. FLOOR 3 + 13/4 V. PINE.
 TYPE. FRAME.. (INSIDE)
 FOUNDATION RUBLE. STONE. PIERS. FINISH. (OUTSIDE)
 WALLS 2x4.
 ROOF { TYPE. GABLE. WOOD. CEILING HEIGHT.
 PITCH 1/3. LIGHTING LAMPS.
 HEATING STOVES. SANITARY FACILITIES. OUTSIDE TOILETS.

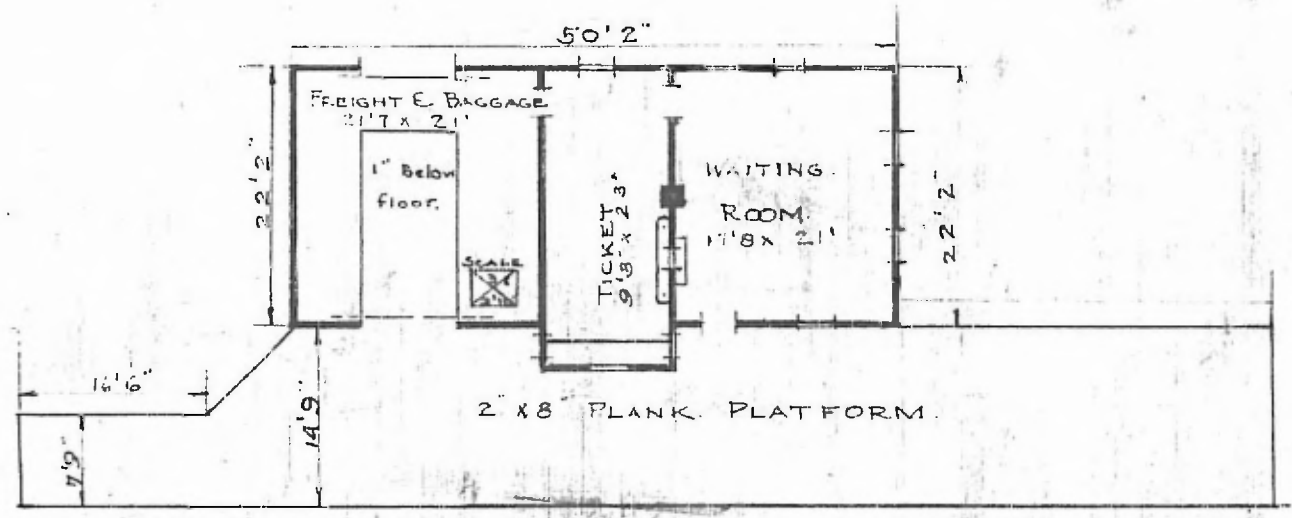

FLOOR PLAN:
 SCALE 1/16" = 1' 0"

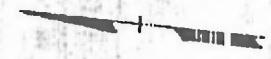

COMBINATION STATION
 GREENFIELD MO.

DEC. 1, 1915.