

•ERECTED: 1892
 •TYPE: FRAME
 •FOUNDATION: PILE HEADS
 •WALLS: 2"x4"
 •ROOF: { Type: Hip
 Pitch:
 •HEATING: STOVES

•FLOOR: 3/4"x3/4" Y.P.
 •FINISH: { INSIDE: 3/4"x3/4" M. & B.
 OUTSIDE:
 •CEILING HEIGHT: 12'0"
 •LIGHTING: OIL LAMPS
 •SANITARY FACILITIES: OUTSIDE TOILETS

NORTHERN DIV.
 ASH GROVE SUB
 STA. NO. 6151

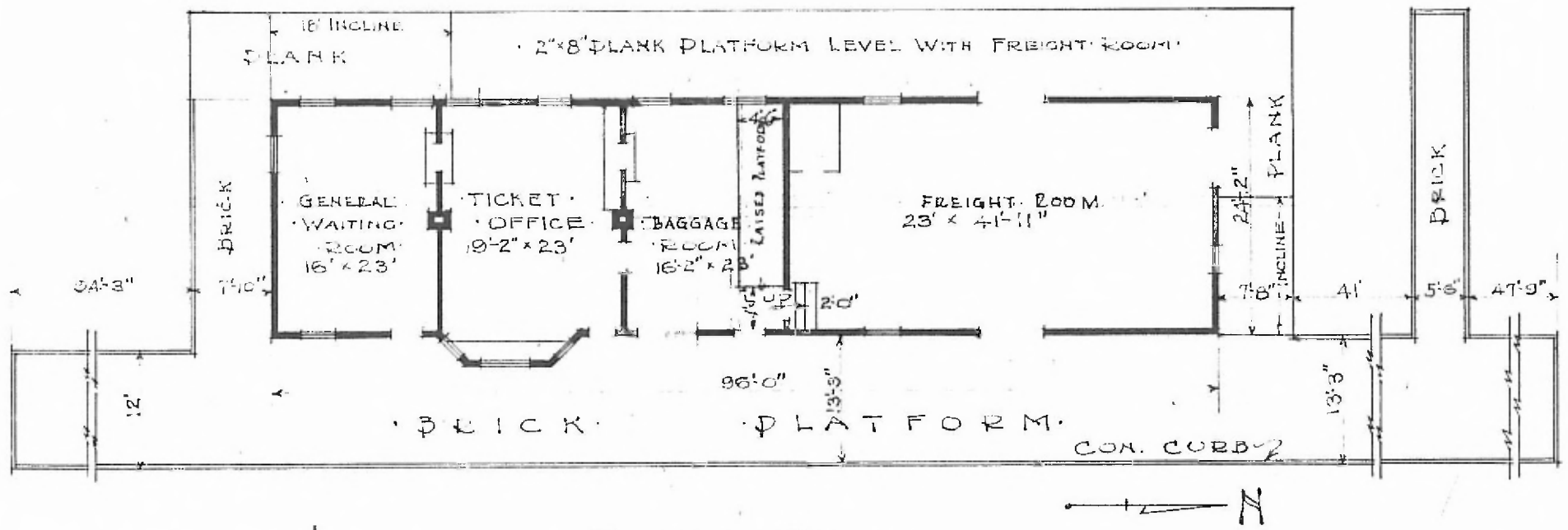

•FLOOR PLAN.
 SCALE 1/16"=1'-0"



NOV. 11, 1919.

•COMBINATION STATION.
 •GOLDEN CITY, MO.