

ERECTED 1892
 TYPE FRAME
 FOUNDATION BLOCKS
 WALLS 2x4
 ROOF { TYPE GABLE SHINGLES
 PITCH 10" RISE
 HEATING STOVES

FLOOR $7\frac{1}{2} \times 3\frac{1}{4}$
 FINISH { INSIDE $7\frac{1}{8} \times 3\frac{1}{2}$ M. & B.
 OUTSIDE
 CEILING HEIGHT 10'-10"
 LIGHTING OIL
 SANITARY FACILITIES NONE?

SOUTHERN DIV.
 RIVER DIV.
 HOVIA SUB
 STA NO TO 216

77

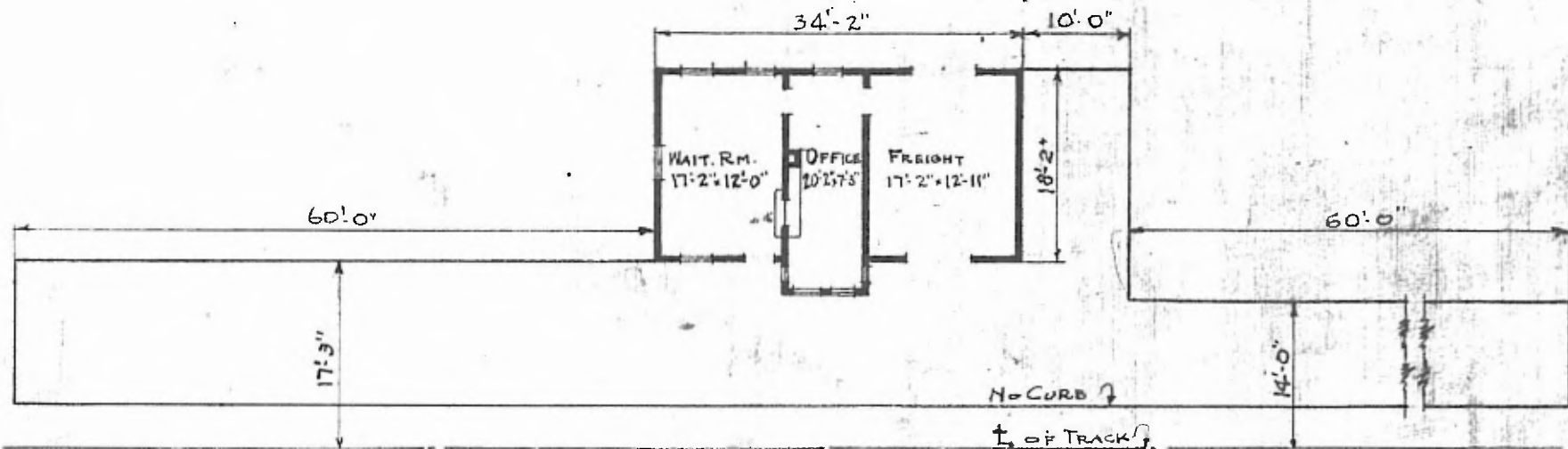

FLOOR PLAN
 SCALE: $\frac{1}{16}'' = 1'-0''$

COMBINATION STATION
 ELSINORE, MO.

SEP. 15, 1919.