

ERECTED 1888  
 TYPE FRAME.  
 FOUNDATION PILE HEADS.  
 WALLS 2"x6"  
 ROOF { TYPE GABLE. SHINGLE.  
 PITCH  $\frac{1}{3}$   
 HEATING STOVES.

FLOOR  $\frac{3}{8} \times 3\frac{1}{2}$ "  
 FINISH { INSIDE  $\frac{3}{8} \times 3\frac{1}{2}$ " V. JOINT.  
 OUTSIDE DOXING & BATTERS.  
 CEILING HEIGHT 12'-0" FET. 12'-9"  
 LIGHTING ELECTRIC. OIL LAMPS.  
 SANITARY FACILITIES. OUTSIDE.

EASTERN DIV.  
 LEBANON SUB  
 STA. NO. 147

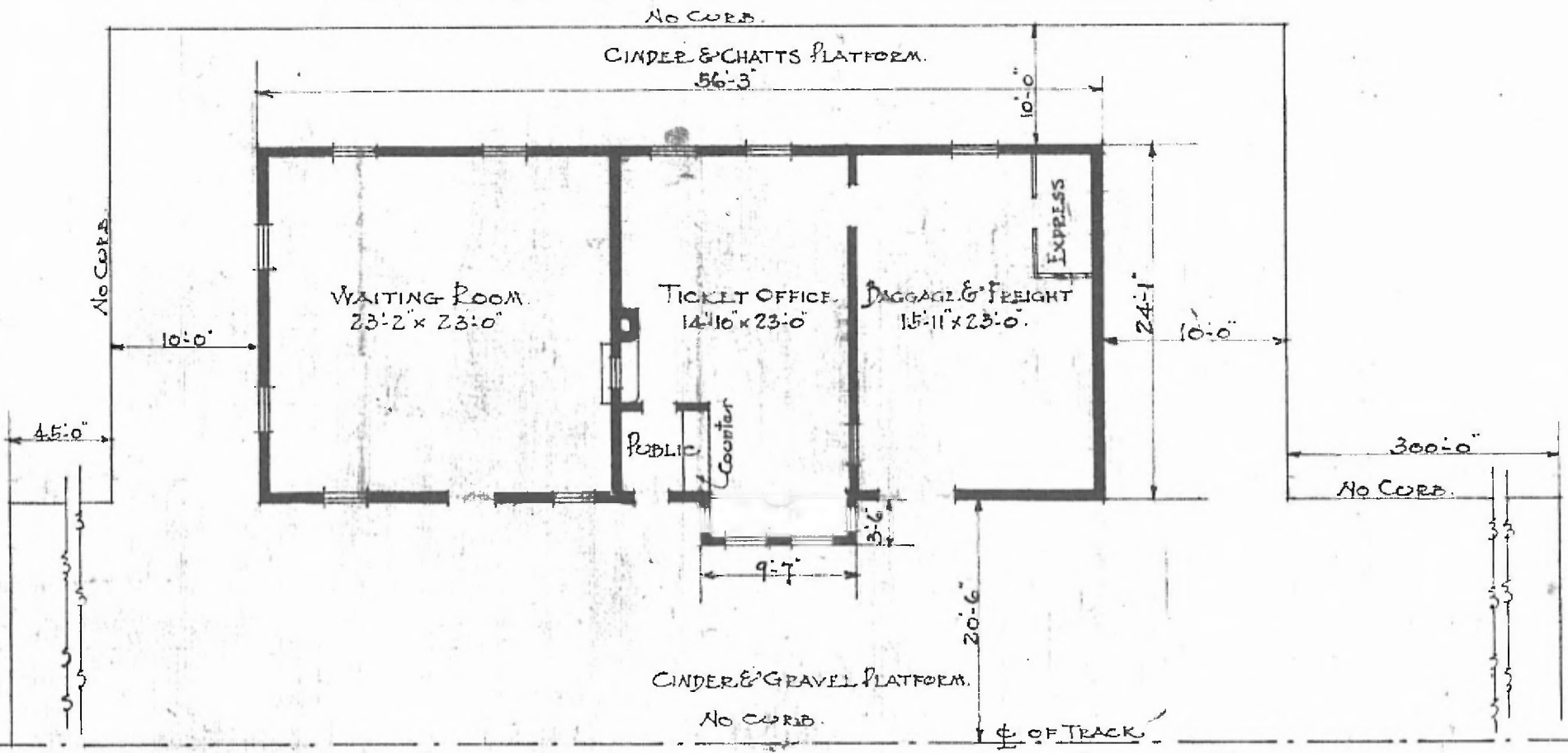

DEC. 22. 1916.



FLOOR PLAN  
 SCALE  $\frac{3}{32} = 1'-0"$

PASSENGER STATION  
 CROCKER, MO.