

RIVER DIV.
ST. LOUIS SUB
STA. NO. T 56

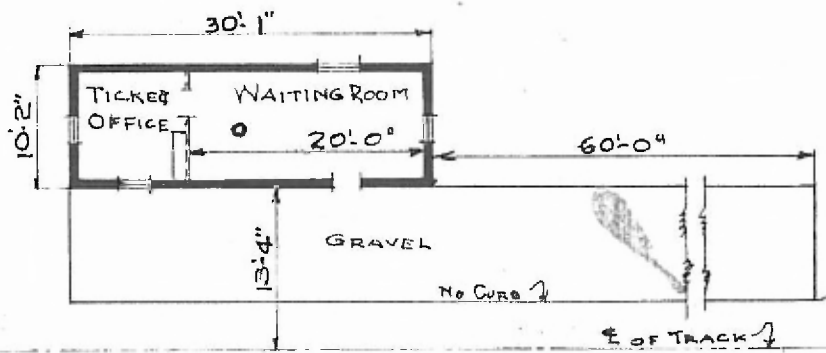

ERECTED	1906	FLOOR	2x12 PLANK
TYPE	FRAME	FINISH	$\frac{3}{4}$ x $3\frac{1}{4}$ BEKD
FOUNDATION	PILE HEADS	FINISH { INSIDE OUTSIDE	BOARDS & BATT.
WALLS	2x4		CEILING HEIGHT
ROOF {	HIP-SHINGLES	LIGHTING	LAMPS
		PITCH	$\frac{1}{3}$
HEATING	STOVES		



FLOOR PLAN
SCALE: $\frac{1}{16}'' = 1'-0''$

PASSENGER STATION
CLEMENT, MO.

Aug. 4, 1917