

ELECTED. 1906.  
 TYPE. FRAME.  
 FOUNDATION. PILE HEADS  
 WALLS. 2"x6"  
 ROOF { TYPE GABLE SHINGLES.  
 PITCH 1/3  
 HEATING. STOVES.

FLOOR. 3/4" x 5 1/4" V. PINE.  
 FINISH { INSIDE 3/4" x 3 1/4" BO. CEILING.  
 OUTSIDE BOARD & BATTIS  
 CEILING HEIGHT. 10'6" FEET. IN 12'6"  
 LIGHTING. LAMPS.  
 SANITARY FACILITIES. OUTSIDE TOILETS.

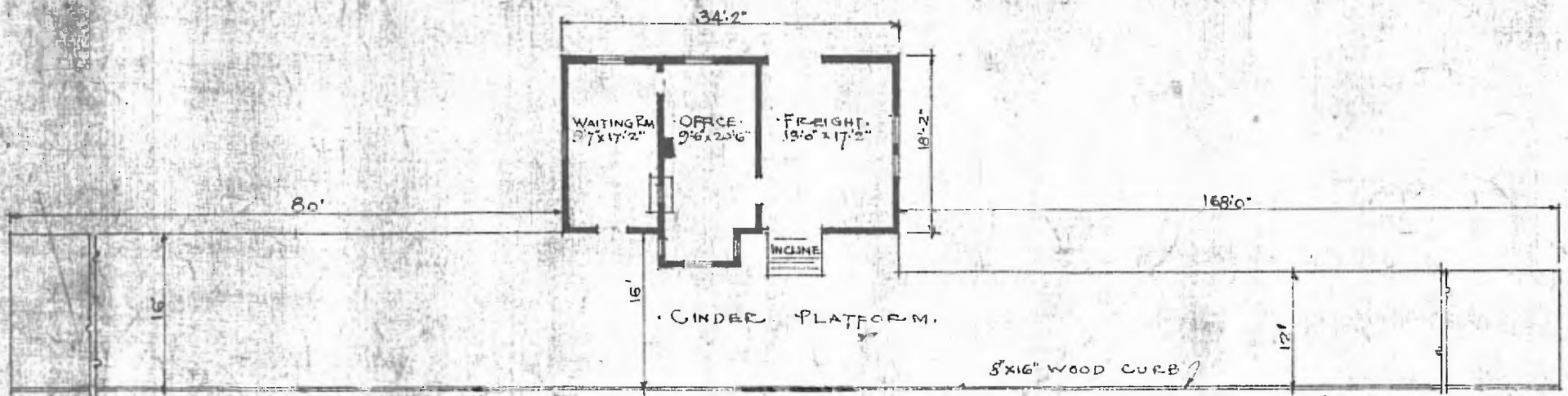

FLOOR PLAN  
 SCALE 1/8" = 1'0"

DIV. CENTRAL  
 SUB. DIV. FT. SMITH  
 STA. No 293



COMBINATION STATION AT  
 BUTTERFIELD, MO.

AUG. 7, 1915