

ERECTED 1918
 TYPE FRAME
 FOUNDATION CONCRETE
 WALLS 2x6
 ROOF { TYPE HIP
 PITCH 10"
 HEATING STOVES

FLOOR
 FINISH { INSIDE
 OUTSIDE
 CEILING HEIGHT
 LIGHTING
 SANITARY FACILITIES

RIVER DIV.
 MERCURVILLE SUB
 STA. NO. 7F222
 7" $\frac{1}{2}$ "
 8x24 MAPLE
 7" $\frac{3}{4}$ " M. & BEVEL JOINT
 4" LAP SIDING - $\frac{1}{2}$ " $\frac{5}{8}$ " DROP SIDING
 11.5"
 OIL LAMPS
 OUTSIDE TOILETS

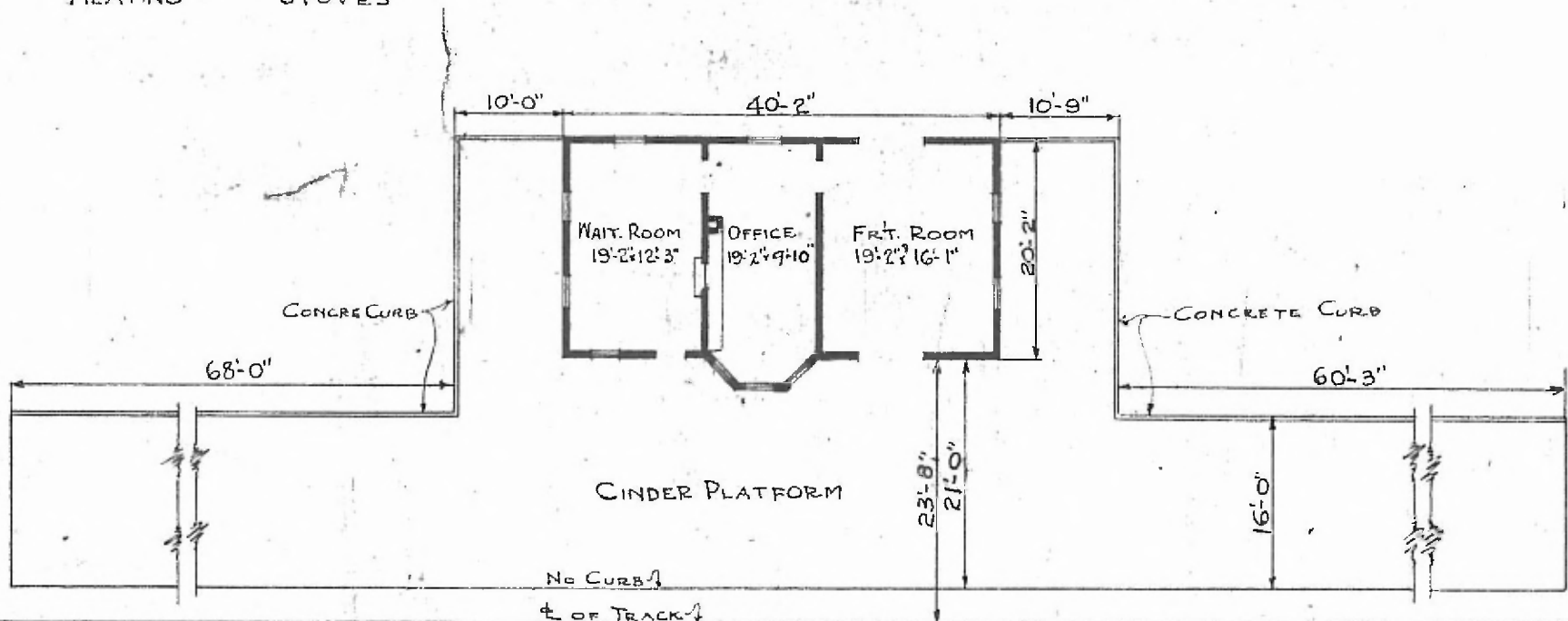

FLOOR PLAN
 SCALE: - $\frac{1}{16}$ " = 1'-0"

COMBINATION STATION
 BRAGG CITY, MO.