

76

ERECTED
 TYPE FRAME
 FOUNDATION PILE HEADS
 WALLS 2" x 4"
 ROOF TYPE - HIP SHINGLES
 PITCH 1/3
 HEATING

FLOOR FINISH { INSIDE
 { OUTSIDE
 CEILING HEIGHT 9'-7"
 LIGHTING —
 SANITARY FACILITIES —

3/4" x 3/4" Y. PINE
 3/4" x 3/4" BD. CEILING
 1" x 6" DROP SIDING
 9'-7"

EASTERN DIV.
 CLINTON SUB
 STA. No. D-25

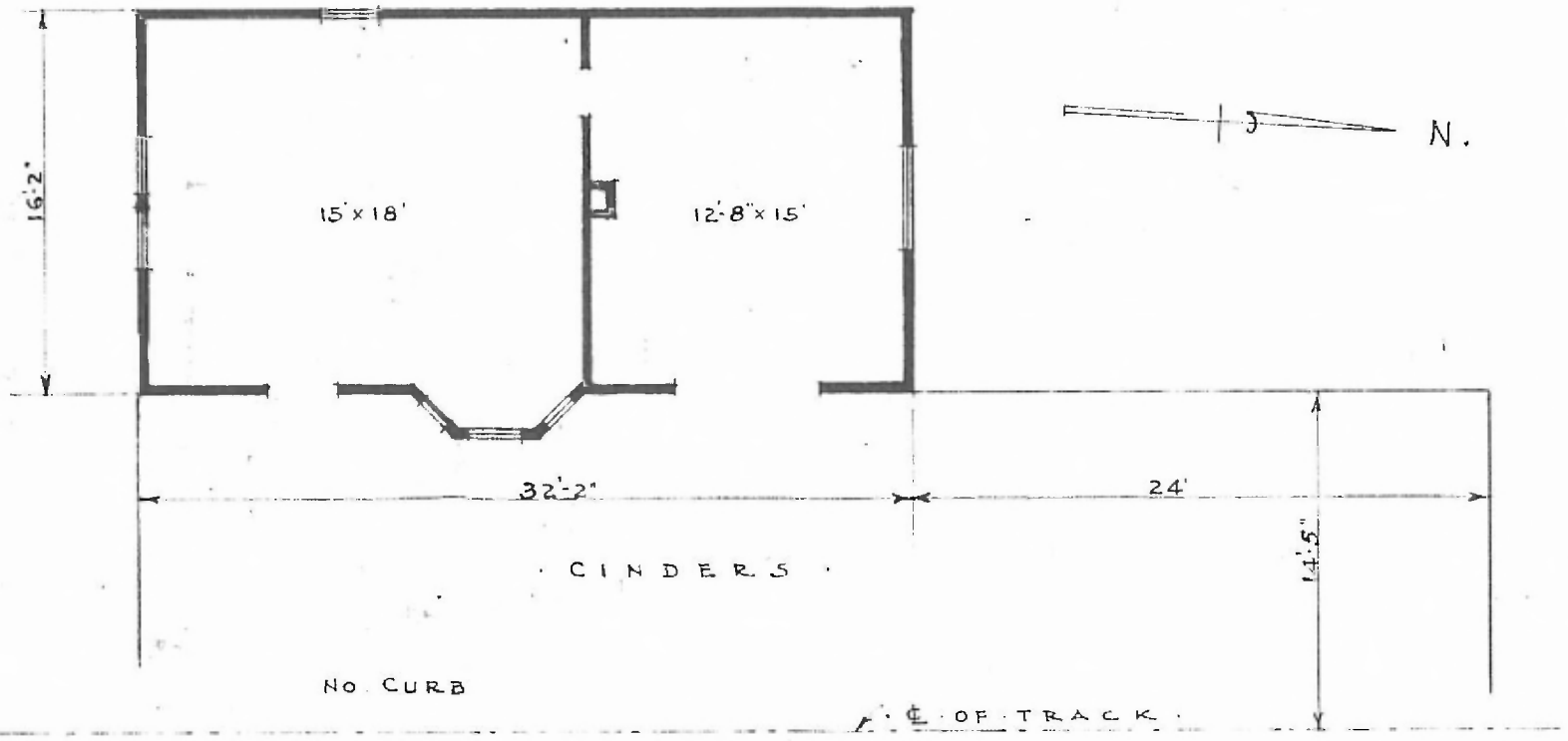

• PASSENGER STATION AT
 • BELVIDERE MO •

• FLOOR PLAN •
 • SCALE: 1/8" = 1'-0" •

NOTE: NOT USED FOR STATION PURPOSES.

• JANUARY 10 1916 •