

•ERECTED: 1879  
 •TYPE: FRAME  
 •FOUNDATION: PILE HEADS  
 •WALLS: 2" x 6"  
 •ROOF: (TYPE: GABLE, SHINGLES  
 PITCH:  $\frac{3}{8}$ )  
 •HEATING: STOVES

•FLOOR:  $\frac{3}{4}$  x  $3\frac{1}{4}$  Y.T.  
 •FINISH: (INSIDE  $\frac{3}{4}$  x  $3\frac{1}{4}$  M.&P.  
 OUTSIDE  
 •CEILING HEIGHT: 4'-7"  
 •LIGHTING: ELECTRIC  
 •SANITARY FACILITIES: OUTSIDE TOILETS

NORTHERN DIV.  
 ASH GROVE SUB  
 STATION C 183

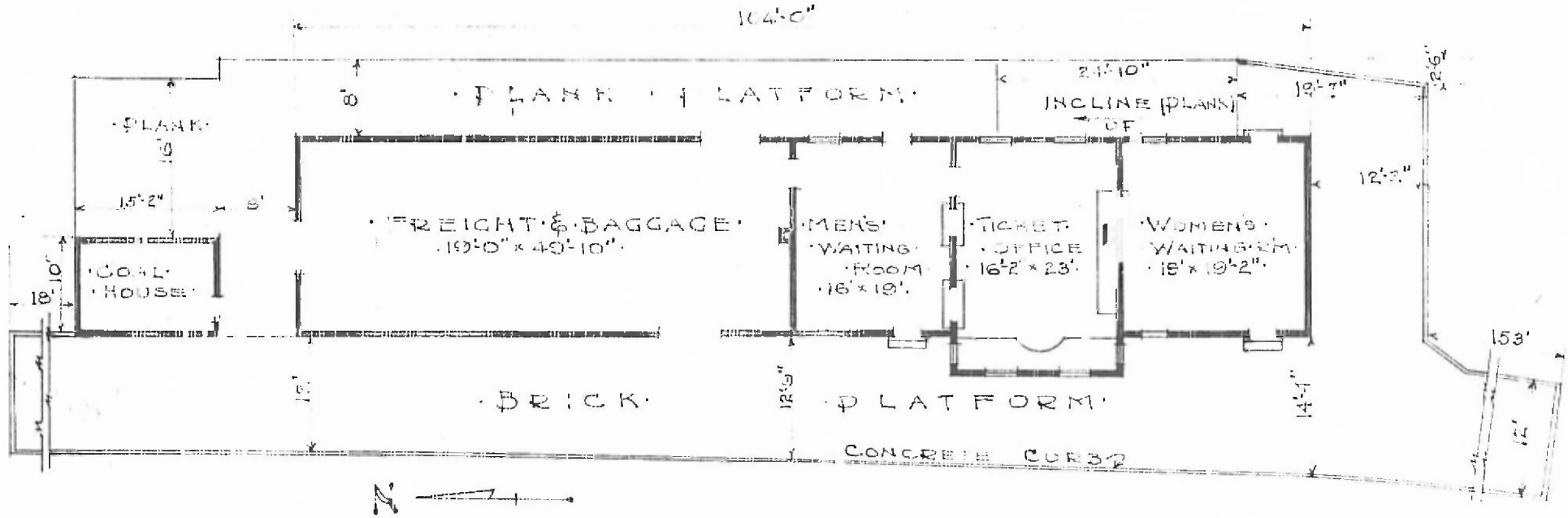

•FLOOR PLAN  
 SCALE  $\frac{1}{16}$ " = 1'-0"

•COMBINATION STATION  
 •ASH GROVE MO.

Nov. 12, 1915.