

ERECTED 1885.  
 TYPE. FRAME.  
 FOUNDATION PILE HEADS.  
 WALLS 2x6  
 ROOF { TYPE. GABLE. SHINGLE.  
 PITCH  $\frac{1}{3}$   
 HEATING STOVES.

FLOOR  $\frac{3}{4}$ " x  $\frac{3}{4}$ " PINE.  
 FINISH { INSIDE  $\frac{3}{4}$ " x  $\frac{5}{2}$ " BEADED.  
 OUTSIDE. BOARDS & PATTONS.  
 CEILING HEIGHT. 12'-2"  
 LIGHTING LAMPS.  
 SANITARY FACILITIES. OUTSIDE..

EASTERN DIV.  
 ROLL# 508  
 STR. NO. 30

23

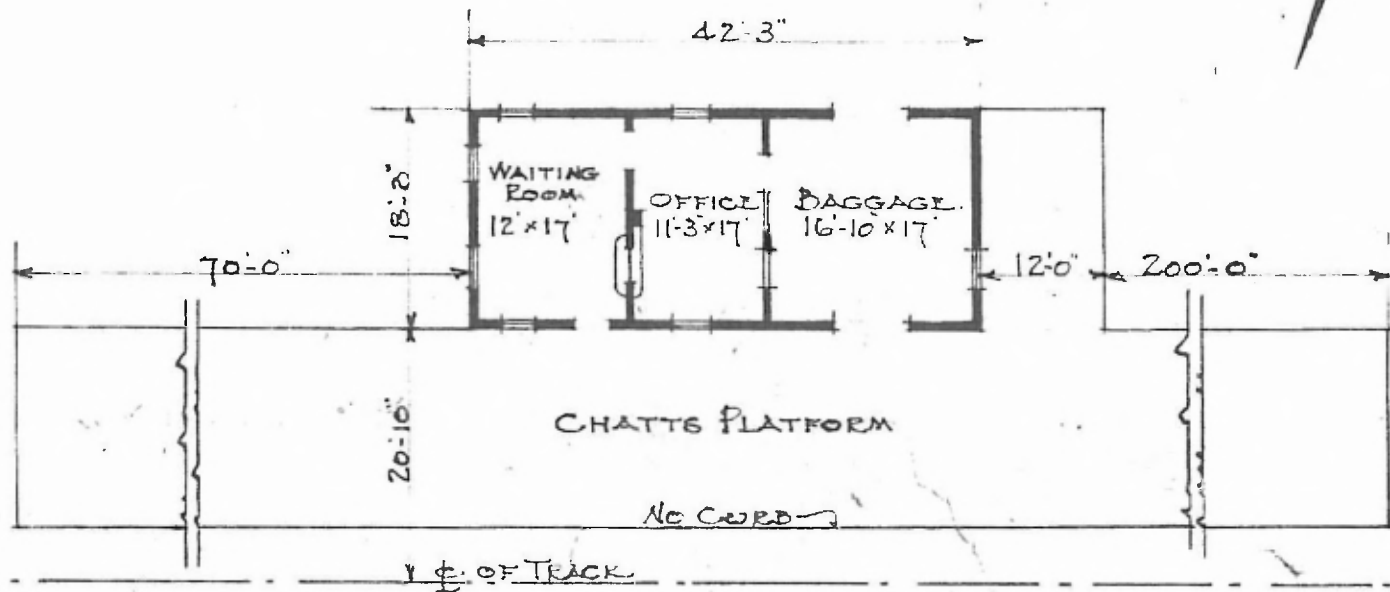

FLOOR PLAN  
 SCALE  $\frac{1}{16}$ " = 1'-0"

PASSENGER STATION  
 ALLENTON, MO.

JAN. 25. 1917.