

50.

ERECTED 1880
 TYPE FRAME
 FOUNDATION PILE HEADS
 WALLS 2x4
 ROOF { TYPE GABLE-SHINGLES
 PITCH $\frac{1}{3}$
 HEATING STOVES

FLOOR $\frac{3}{4}$ " x $\frac{3}{4}$ " Y.P.
 FINISH { INSIDE
 OUTSIDE
 CEILING HEIGHT $\frac{3}{4}$ " x $\frac{5}{4}$ " BEEDED CEILING
 BOARDS & BATT.
 LIGHTING OIL LAMPS
 SANITARY FACILITIES OUTSIDE TOILETS.

DIV. SOUTHERN
 SUB. DIV. TOPELO
 STA. NO. C-520

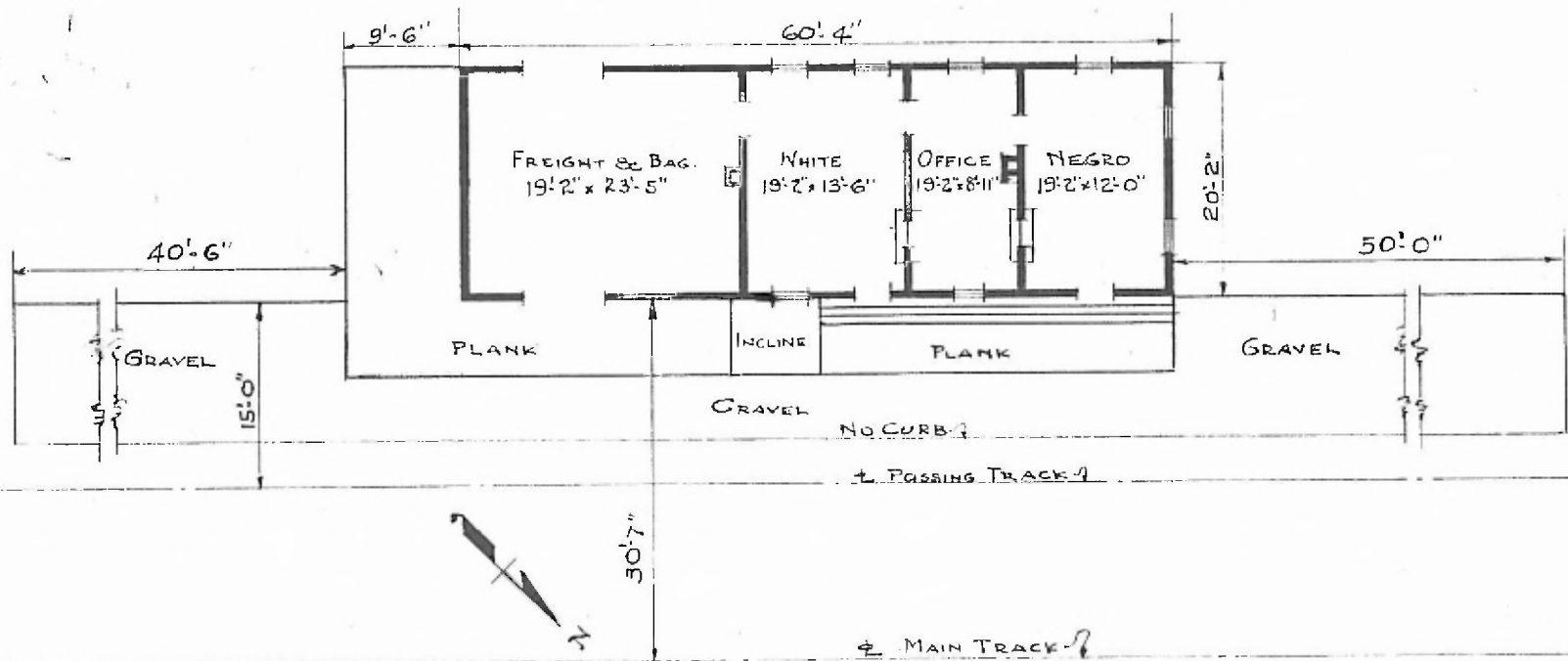

FLOOR PLAN
 SCALE: $\frac{1}{16}$ " = 1'-0"

COMBINATION STATION
 RED BANKS, MISS.

SEPT. 9, 1919.