

ERECTED 1880
 TYPE FRAME
 FOUNDATION PILE HEADS
 WALLS 2"
 ROOF { TYPE GABLE - SHINGLES
 PITCH $\frac{1}{3}$
 HEATING STOVES

FLOOR $\frac{3}{4} \times 3\frac{1}{2}$ " Y.P.
 FINISH { INSIDE
 OUTSIDE
 CEILING HEIGHT 11'-7"
 LIGHTING OIL LAMPS
 SANITARY FACILITIES OUTSIDE TOILETS

SUB DIV. TUPELO STA. NO. C-502

69

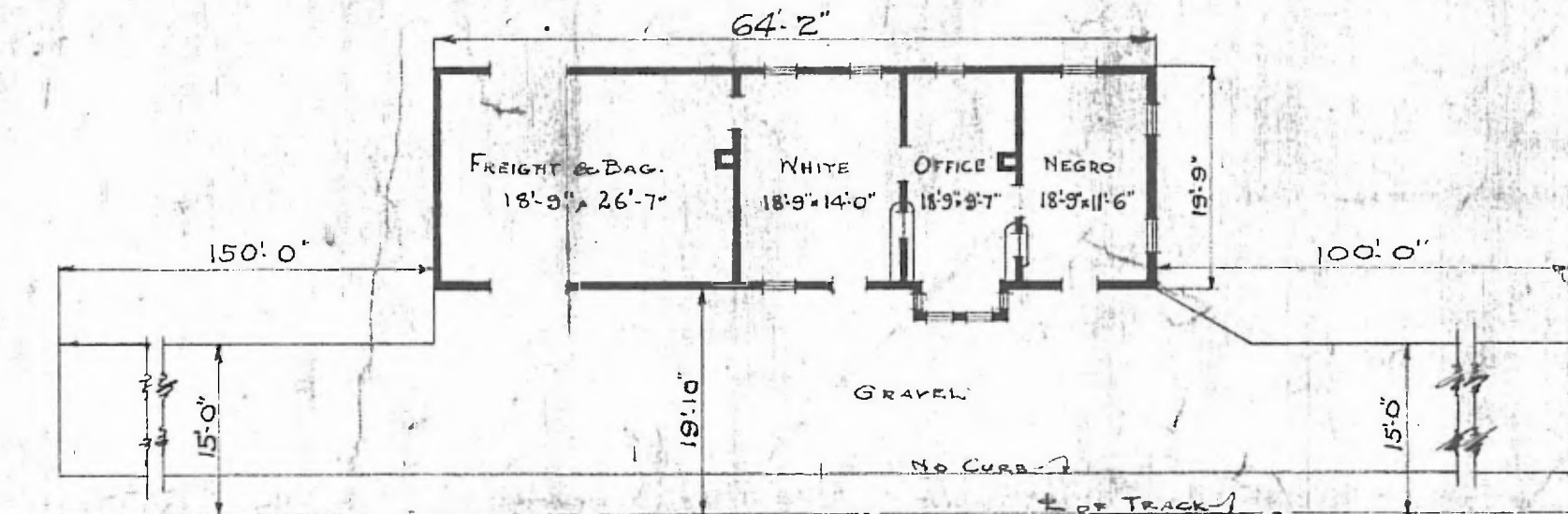

FLOOR PLAN
 SCALE: $\frac{1}{16}'' = 1'-0''$

COMBINATION STATION
 OLIVE BRANCH, MISS.

SEP. 9, 1919