

46

DIV. SOUTHERN
SUB. DIV. TUPELO
STA. NO. C 499

ERECTED .
 TYPE . FRAME
 FOUNDATION . PILE HEADS .
 WALLS . 2x6" STUDS .
 ROOF . { TYPE . GABLE - SHINGLES .
 PITCH . APPROX. 1/3 PITCH .
 HEATING . STOVES .

FLOOR . 7/8" x 3 1/2" YELLOW PINE S.F.A. NO. C 499
 FINISH . { INSIDE . 7/8" x 3 1/2" E.S.P. m. e. b .
 OUTSIDE . BOARDS . E. BATTIS - DROP SIDING .
 CEILING HEIGHTS . 11'9" WAITING RMS. T.O; 11'10" F. RM. (OPEN)
 LIGHTING . OIL LAMPS .
 SANITARY FAC. . OUTSIDE TOILETS .

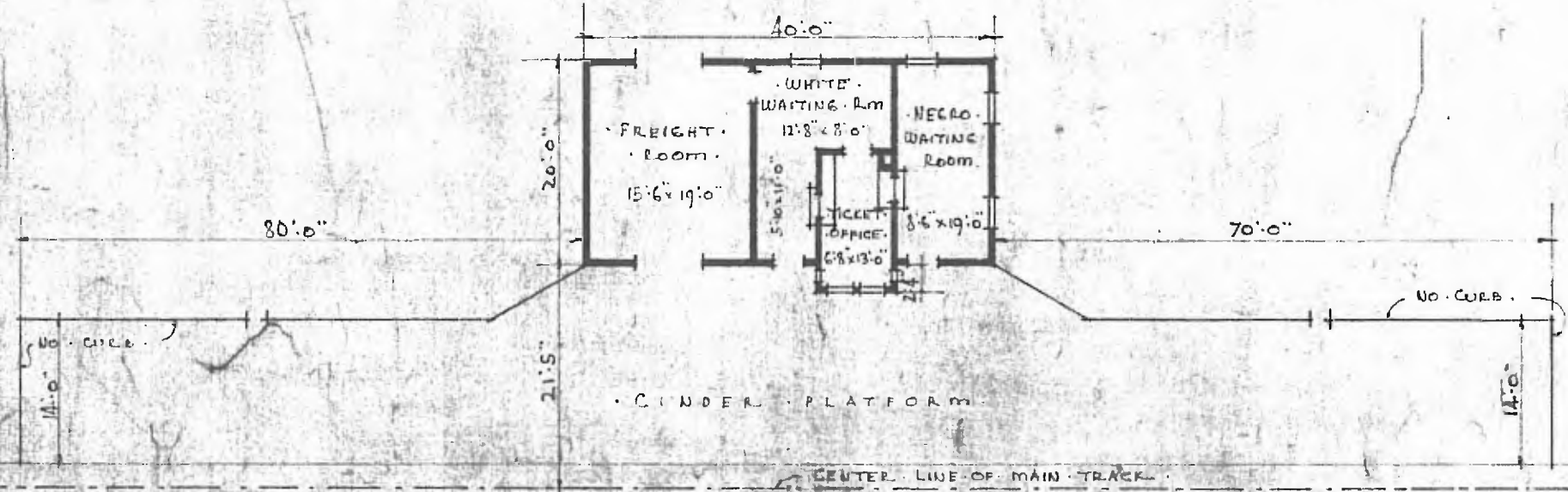

FLOOR PLAN
 SCALE 1/2" = 1'0"

COMBINATION - STATION - AT -
 MINERAL WELLS - MISS.



JANUARY - 10 - 1918.