

ERECTED 1910
 TYPE FRAME
 FOUNDATION PILE HEADS
 WALLS 2x4
 ROOF { TYPE HIP SHINGLES
 PITCH $\frac{1}{3}$
 HEATING STOVES

FLOOR
 FINISH { INSIDE
 OUTSIDE
 CEILING HEIGHT 11'-9"
 LIGHTING OIL LAMPS
 SANITARY FACILITIES NONE

DIV. SOUTHERN
 SUBDIV. TUNNEL
 ST. NO. 6523

51

$\frac{3}{4}$ " x $3\frac{1}{2}$ " Y.P.
 $\frac{3}{4}$ " x $3\frac{1}{2}$ " V. JOINT CEILING
 BOARDS & BATTENS
 11'-9"
 OIL LAMPS
 NONE

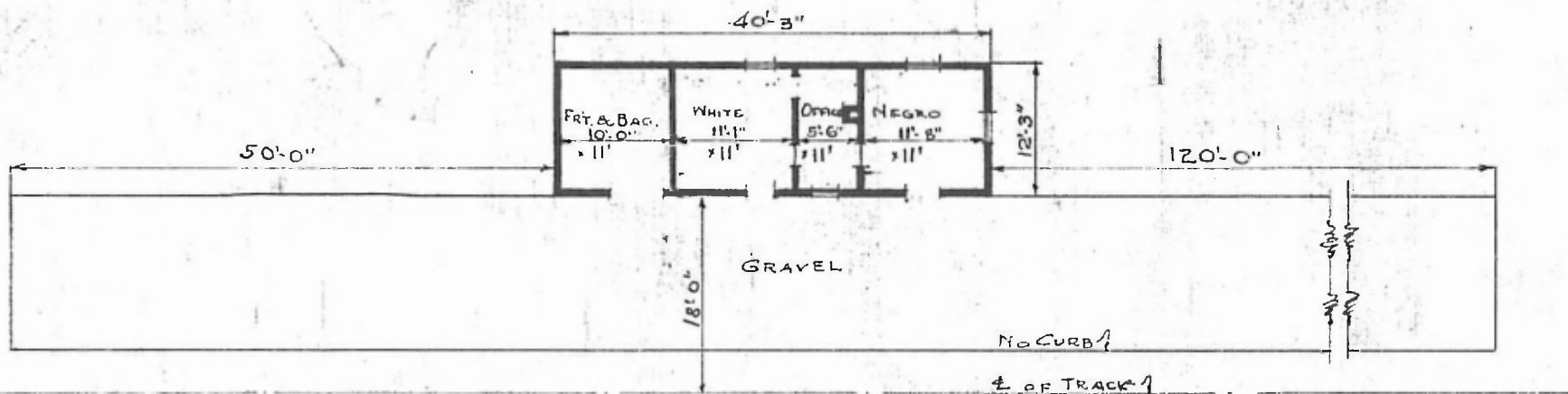

FLOOR PLAN
 SCALE: $\frac{1}{16}$ " = 1'-0"

COMBINATION STATION AT
 MAHON MISS