

DIV. SOUTHERN
SUB-DIV. TUPELO
STA. NO. C 548

- ERECTED.
- TYPE: FRAME.
- FOUNDATION: PILE HEADS.
- WALLS: 2x6.
- ROOF: TYPE: GABLE SHINGLE. PITCH: 1/3.
- HEATING: STOVES.
- FLOOR: INSIDE.
- FINISH: (OUTSIDE).
- CEILING HEIGHTS: W. RM. 10'11" - FRGT. RM. 11'4"
- LIGHTING: LAMPS.
- SANITARY FACILITIES: OUTSIDE TOILETS.

7/8 x 3 1/4
1/8 x 3 1/4 M & B.
BOXING E. BATTENS

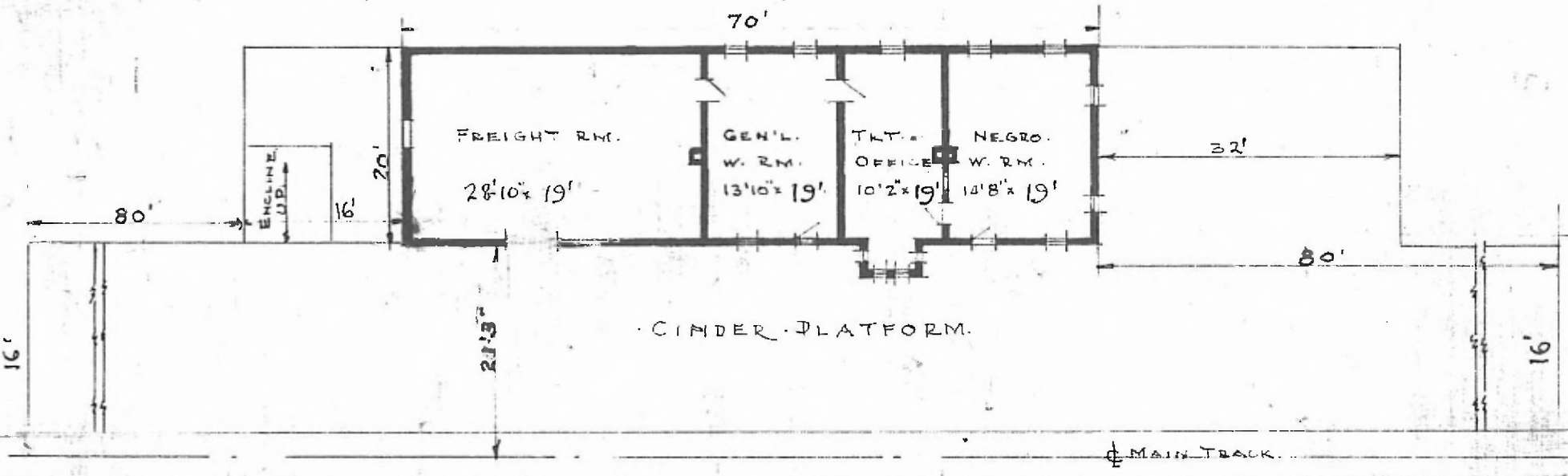

FLOOR PLAN.
SCALE 1/16" = 1'-0"

• COMBINATION STATION AT
• HICKORY FLAT MISS.



FEB. 22, 1918