

·ERECTED·
 ·TYPE· FRAME
 ·FOUNDATION· PILE HEADS
 ·WALLS· 2" x 6"
 ·ROOF· TYPE· GABLE, SHINGLES
 ·PITCH· 1/3
 ·HEATING· STOVES

·FLOOR·
 ·FINISH· { INSIDE
 OUTSIDE·
 ·CEILING HEIGHT·
 ·LIGHTING· OIL LAMPS
 ·SANITARY FACILITIES· OUTSIDE TOILETS.

DIV. NORTHERN
 SUB. DIV. BURTON
 ST. No. F-515

103

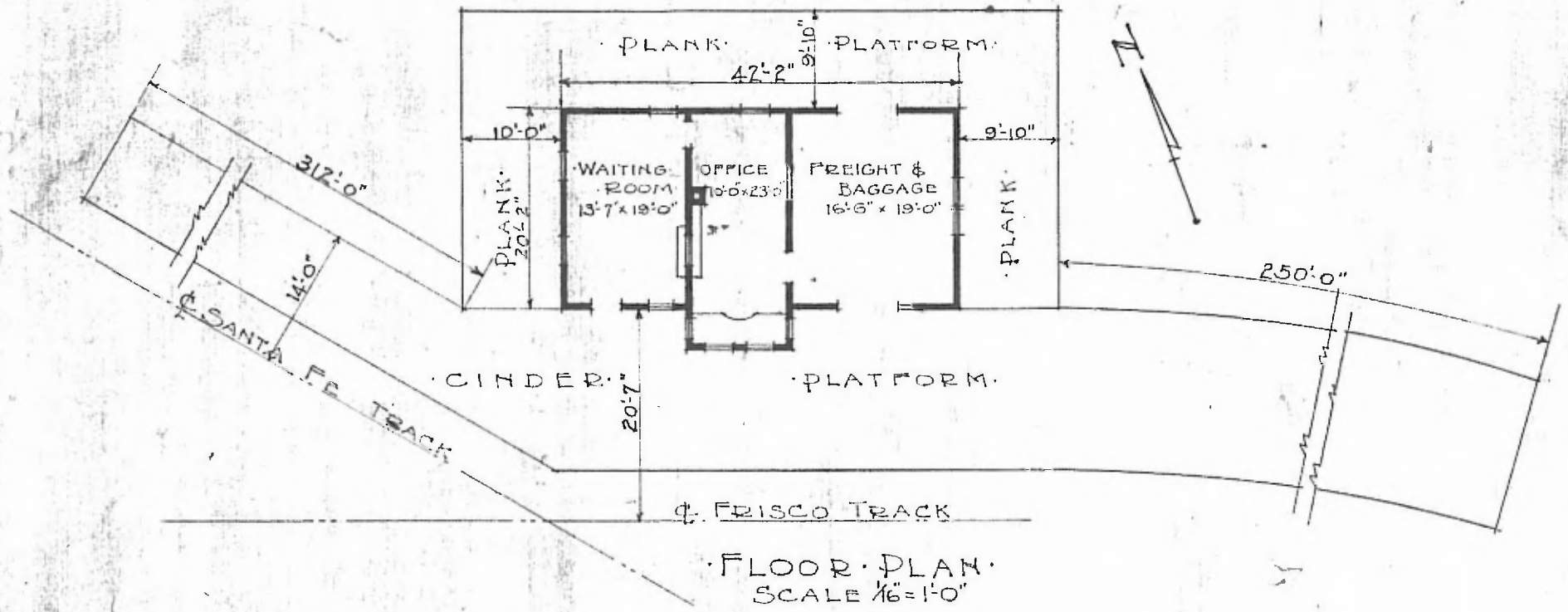

APRIL 19, 1919

·COMBINATION·STATION·
 ·VALLEY·CENTER·KANS.