

ERECTED: 1887
 TYPE: FRAME
 FOUNDATION: PILE HEADS
 WALLS: 2"x6"
 ROOF: TYPE: GABLE, SHINGLES.
 PITCH: 1/3
 HEATING: STOVES

FLOOR: 3/4" x 3 1/2" Y.P.
 FINISH: { INSIDE: 3/4" x 3 1/2" M. & B.
 OUTSIDE: 1" x 6" DROP SIDING
 CEILING HEIGHT: 10'-11"
 LIGHTING: OIL LAMPS
 SANITARY FACILITIES: OUTSIDE TOILET

DIV. NORTHERN
 SUB DIV. BERRFON
 STA. 170 F-570

109

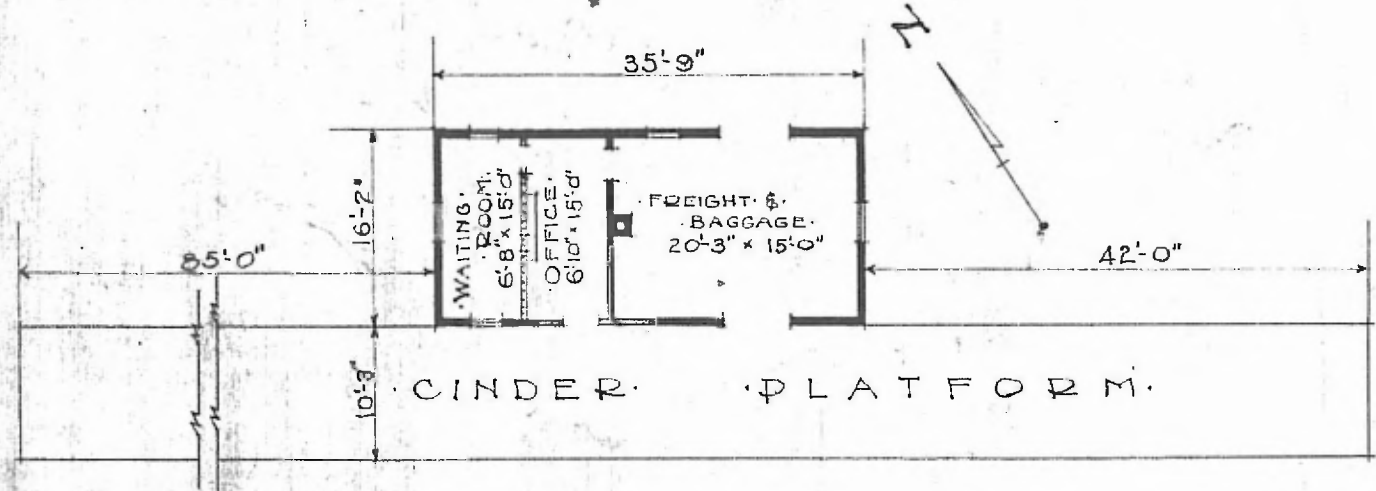

FLOOR PLAN
 SCALE 1/16" = 1'-0"

APRIL 28, 1919.

COMBINATION STATION
 SAXMAN KANS.