

·ERECTED· 1887
 ·TYPE· FRAME
 ·FOUNDATION· PILE HEADS
 ·WALLS· 2" x 4"
 ·ROOF· { TYPE· GABLE, SHINGLES
 PITCH· $\frac{1}{3}$
 ·HEATING· STOVES

·FLOOR· $\frac{3}{4}$ " x $\frac{3}{4}$ " Y.P.
 ·FINISH· { INSIDE·
 OUTSIDE· $\frac{3}{4}$ " x $\frac{3}{4}$ " M. & B.
 ·CEILING HEIGHT· 11'-4"
 ·LIGHTING· OIL LAMPS.
 ·SANITARY FACILITIES· OUTSIDE TOILET.

DIV. NORTHERN
 SUB. DIV. BURTON
 STA. No. F-532 (105)

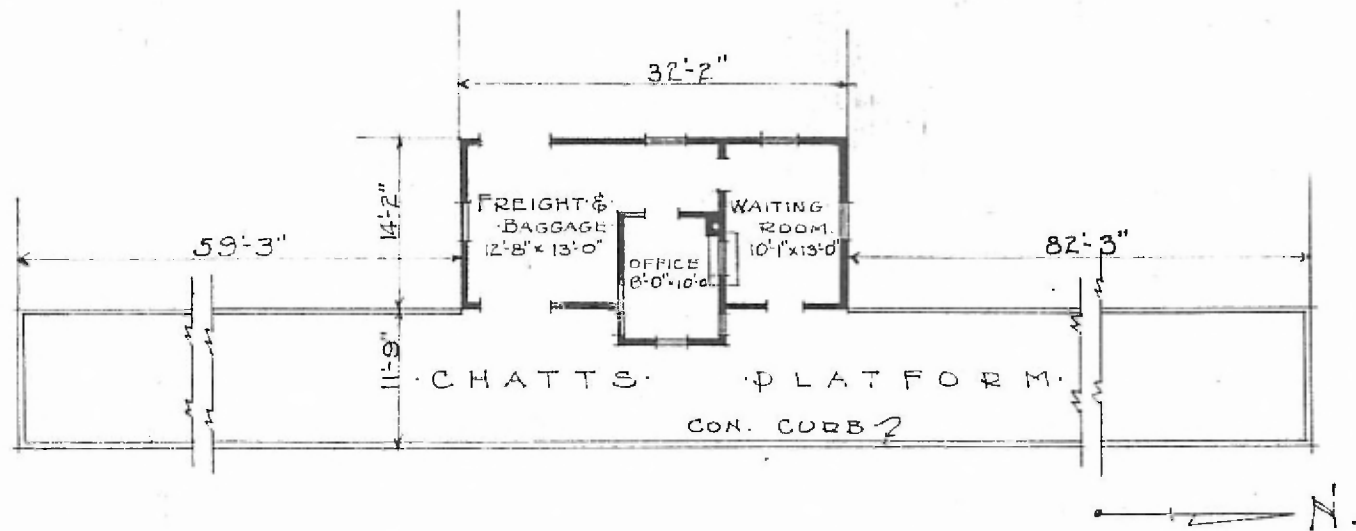

·FLOOR PLAN·
 SCALE $\frac{1}{16}$ " = 1'-0"

April 30, 1919.

·COMBINATION STATION·
 ·PATTERSON · KANS.