

20

ERECTED. 1900.
 TYPE. BRICK.
 FOUNDATION. STONE.
 WALLS 9" BRICK.
 ROOF { TYPE. HIP SLATE SHINGLES
 PITCH. 1/2
 HEATING. STEAM.

FLOOR 3/4" x 3/4" Y. PINE. DIV. NORTHERN
 SUB. DIV. KANSAS CITY
 STA. NO. C-43
 FINISH { INSIDE. PLASTER. B.C. WAINSCOT 3-11" HIGH.
 OUTSIDE. PRESS BRICK
 CEILING HEIGHT. 11'-8"
 LIGHTING. ELECTRIC. 2 WIRE. 110 A.C.
 SANITARY FACILITIES. OUTSIDE TOILETS.

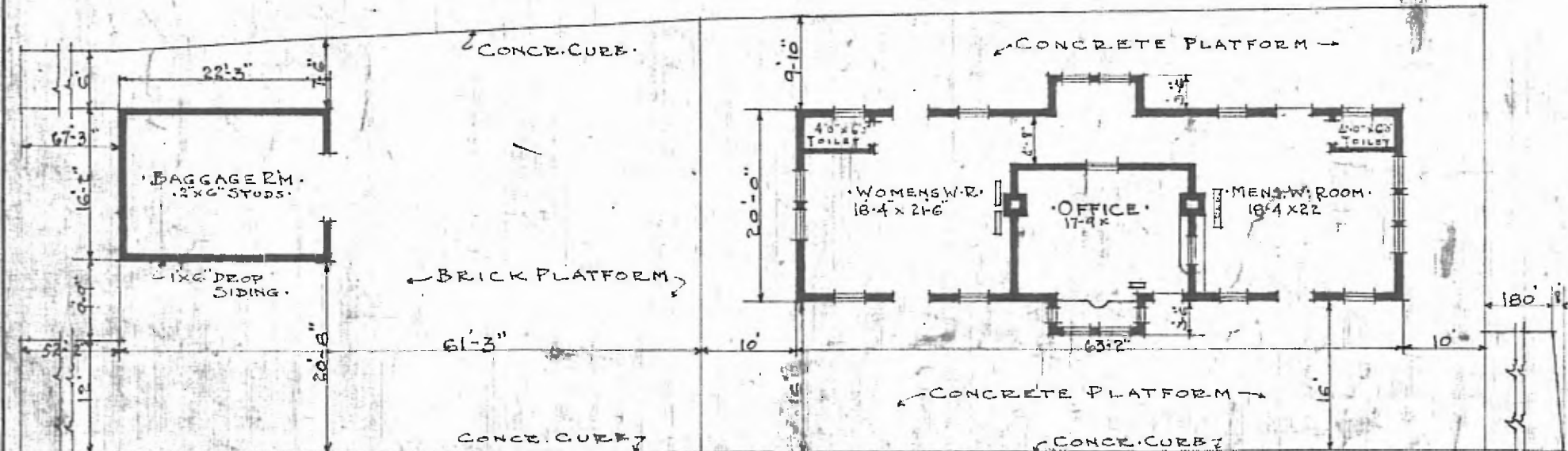

FLOOR PLAN.
 SCALE 1/8" = 1'-0"

APRIL 14 1928

PASSENGER STATION.
 DAOLA KANS.