

- ERECTED 1887
- TYPE FRAME.
- FOUNDATION PILE HEADS
- WALLS 2" x 6"
- ROOF TYPE GABLE, SHINGLES
- PITCH 3/8
- HEATING STOVES.

- FLOOR 3/4" x 3/4" Y.P.
- FINISH { INSIDE 3/4" x 3/4" M. & B.
- { OUTSIDE BOARDS AND BATTENS
- CEILING HEIGHT 12'-5"
- LIGHTING OIL LAMPS
- SANITARY FACILITIES OUTSIDE TOILET.

Sta. F594
 Sub Burton
 Div Northern

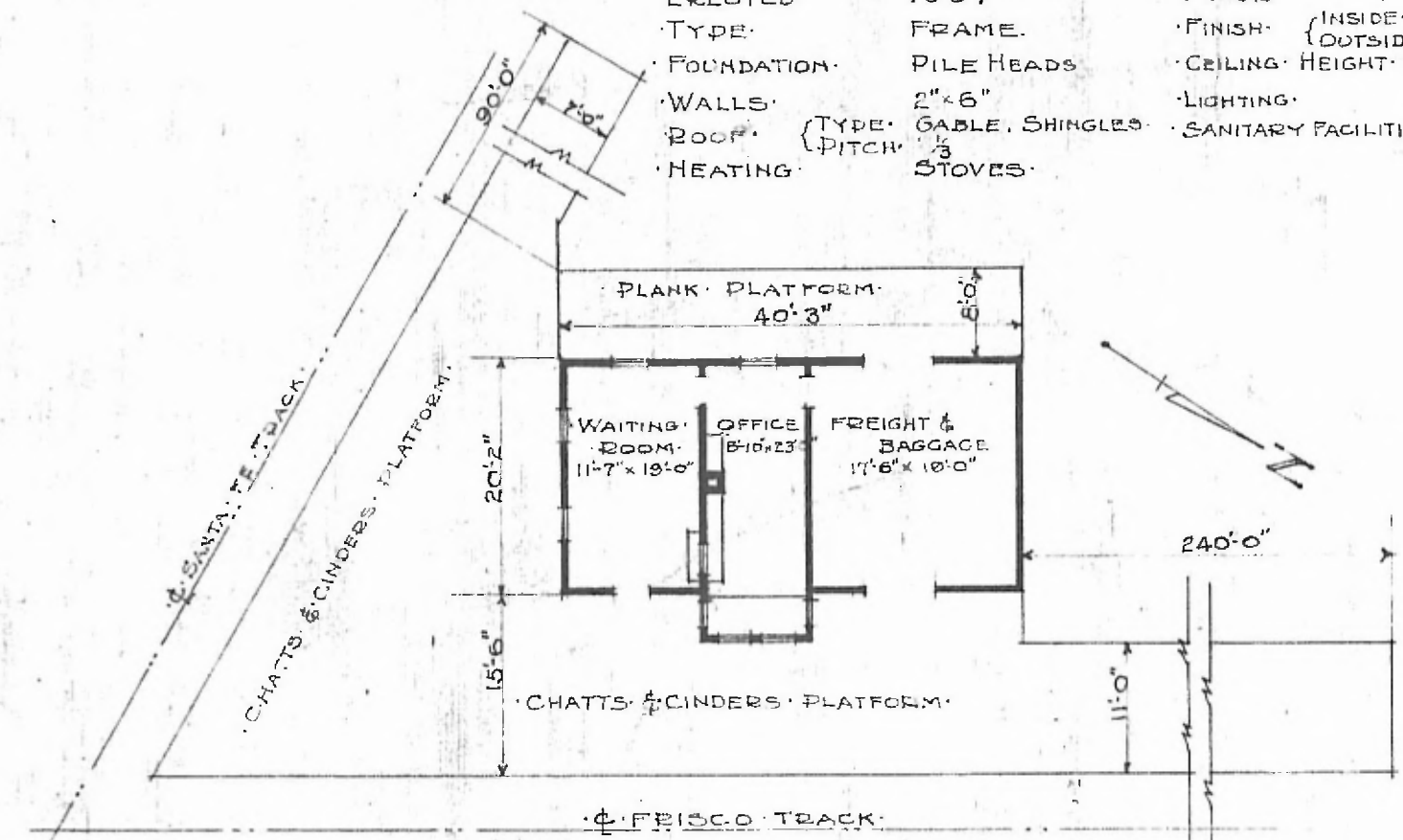

• FLOOR PLAN •
 SCALE 1/16" = 1'-0"

• COMBINATION STATION •
 • LORRAINE KANS.

APRIL 27, 1917.