

ERECTED: 1890
 TYPE: FRAME
 FOUNDATION: PILE HEADS
 WALLS: 2"x6"
 ROOF: { TYPE: GABLE SHINGLES
 PITCH: $\frac{1}{3}$
 HEATING: STOVES

DIV. NORTHERN
 FLOOR: 3" x 3 1/4" Y.P. SUB. PL. WICHITA
 FINISH: { INSIDE: 3/4" x 3 1/4" M. & B. STD. No. F-465
 OUTSIDE: 1" x 12" BOARDS & BATTENS.
 CEILING HEIGHT: 10' 5"
 LIGHTING: OIL LAMPS.
 SANITARY FACILITIES: OUTSIDE TOILET.

99

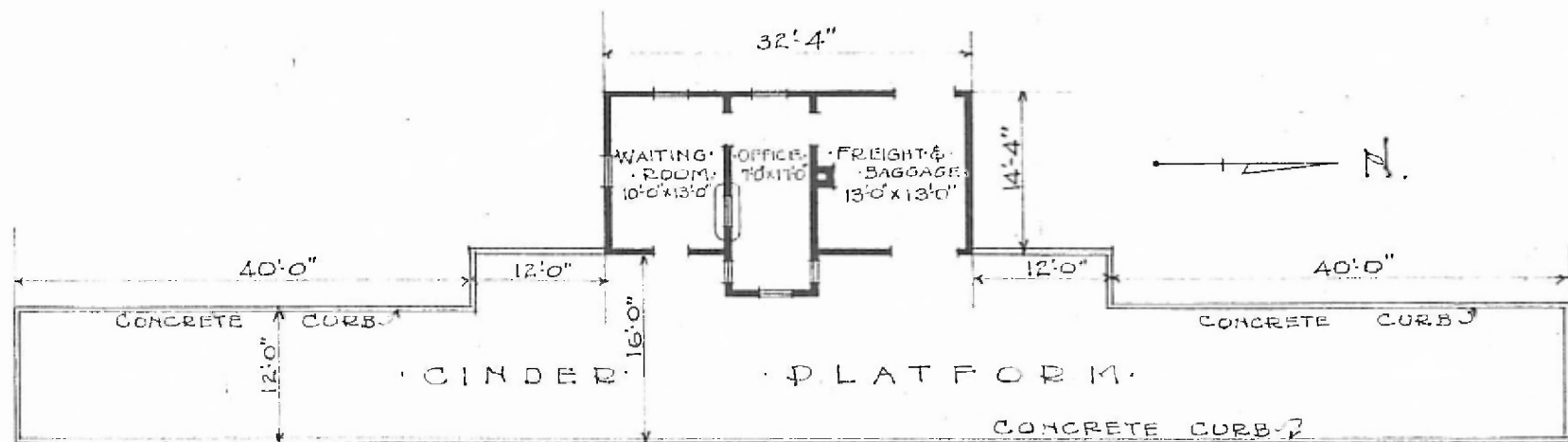

FLOOR PLAN
 SCALE 1/16" = 1'-0"

COMBINATION STATION
 KEIGHLEY, KANS.

APRIL 7, 1919.