

ERECTED 1880
 TYPE FRAME
 FOUNDATION PILE HEADS
 WALLS 2"x6"
 ROOF TYPE - GABLE - SHINGLES
 PITCH - 1/3
 HEATING GAS STOVE

FLOOR 7/8"x3 1/4" Y.P.
 FINISH { INSIDE - 7/8"x3 1/4" M. & B. Y.P.
 { OUTSIDE - 7/8"x5 1/4" DROP SIDING
 CEILING HEIGHT 13'-3"
 LIGHTING GAS
 SANITARY-FACILITIES- OUTSIDE TOILETS

DIV. NORTHERN
 SUB-DIV. WICHITA

87

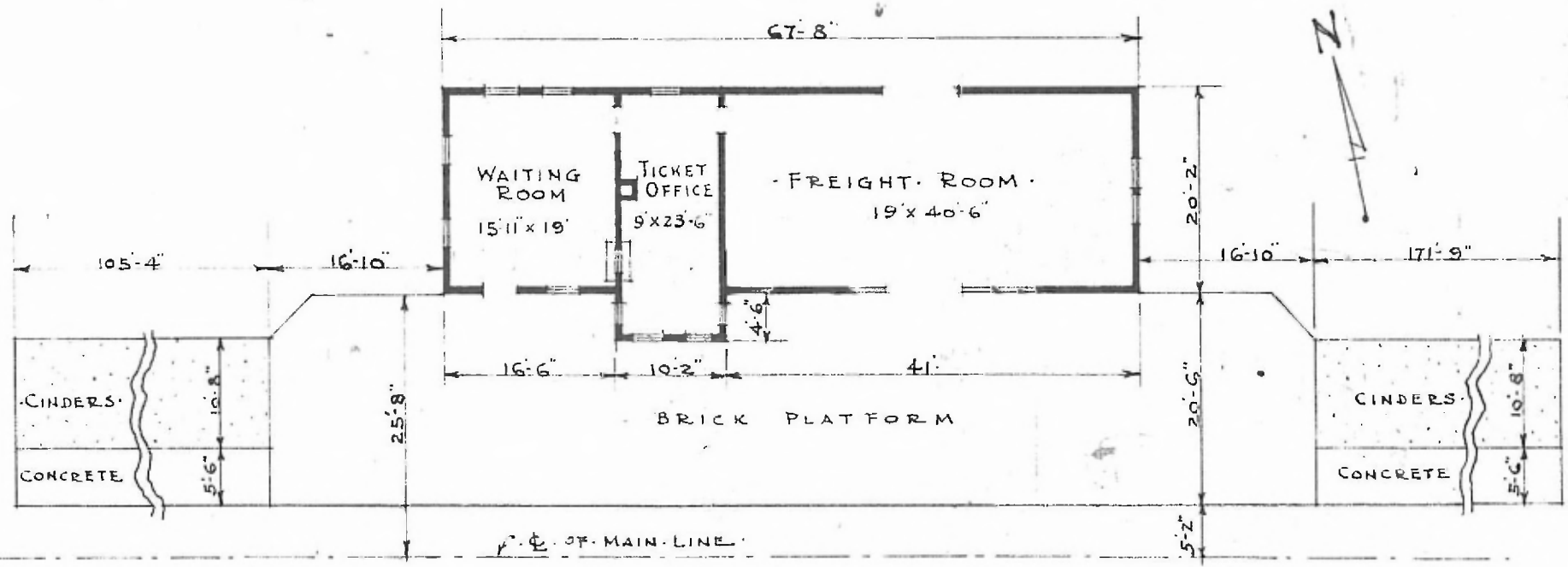

FLOOR PLAN

SCALE: 1/16" = 1'-0"

PASSENGER STATION AT
 FALL RIVER KAN.