

·ERECTED· 1910
 ·TYPE· FRAME·
 ·FOUNDATION· CONCRETE
 ·WALLS· 2"x6"
 ·ROOF· { TYPE· Hip, SHINGLES
 PITCH· 1/3
 ·HEATING· STOVES

·FLOOR· 2 1/2" MAPLE
 ·FINISH· { INSIDE· 3/4" x 3/4" M&B.
 OUTSIDE· 1/2" x 4" LAP SIDING
 ·CEILING HEIGHT· STD.
 ·LIGHTING· ELECTRIC
 ·SANITARY FACILITIES· OUTSIDE TOILETS

DIV. NORTHERN
 SOUTHERN DIV. BERTON
 STA. NO. F-608

113

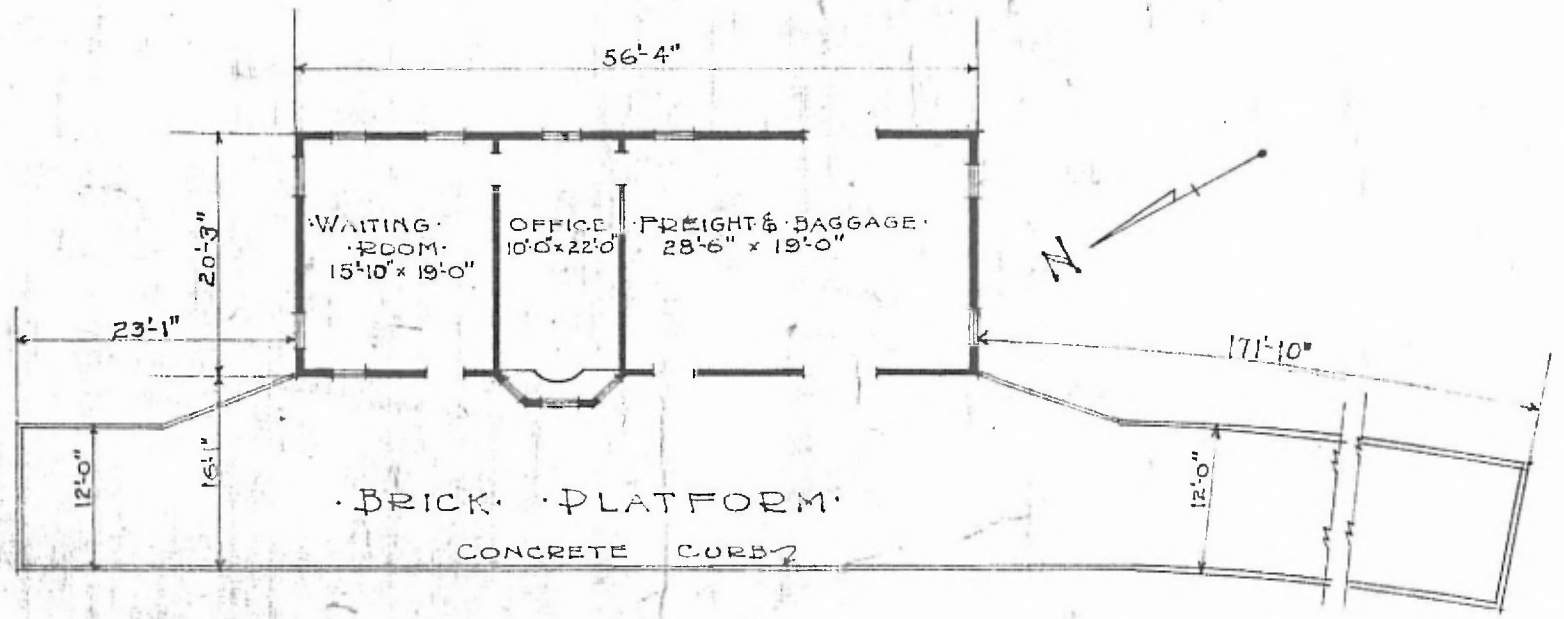

·FLOOR PLAN·
 SCALE 1/16" = 1'-0"

·COMBINATION STATION·
 ·ELLSWORTH KANS·

APRIL 29, 1917.