

ERECTED 1877
 TYPE FRAME
 FOUNDATION PILE HEADS
 WALLS 2" x 4"
 ROOF { TYPE - GABLE - SHINGLES.
 PITCH - 1/4.
 HEATING STOVE.

FLOOR 7/8" x 5 1/4"
 FINISH { INSIDE 7/8" x 5 1/4" M. & B. WHITE PINE.
 OUTSIDE 1" x 12" BOARDS & BATTENS.
 CEILING HEIGHT 11'-2"
 LIGHTING OIL LAMPS.
 SANITARY FACILITIES - OUTSIDE TOILET.

DIV. NORTHERN
 SUB. DIV. CARTHAGE
 STA. NO F 334

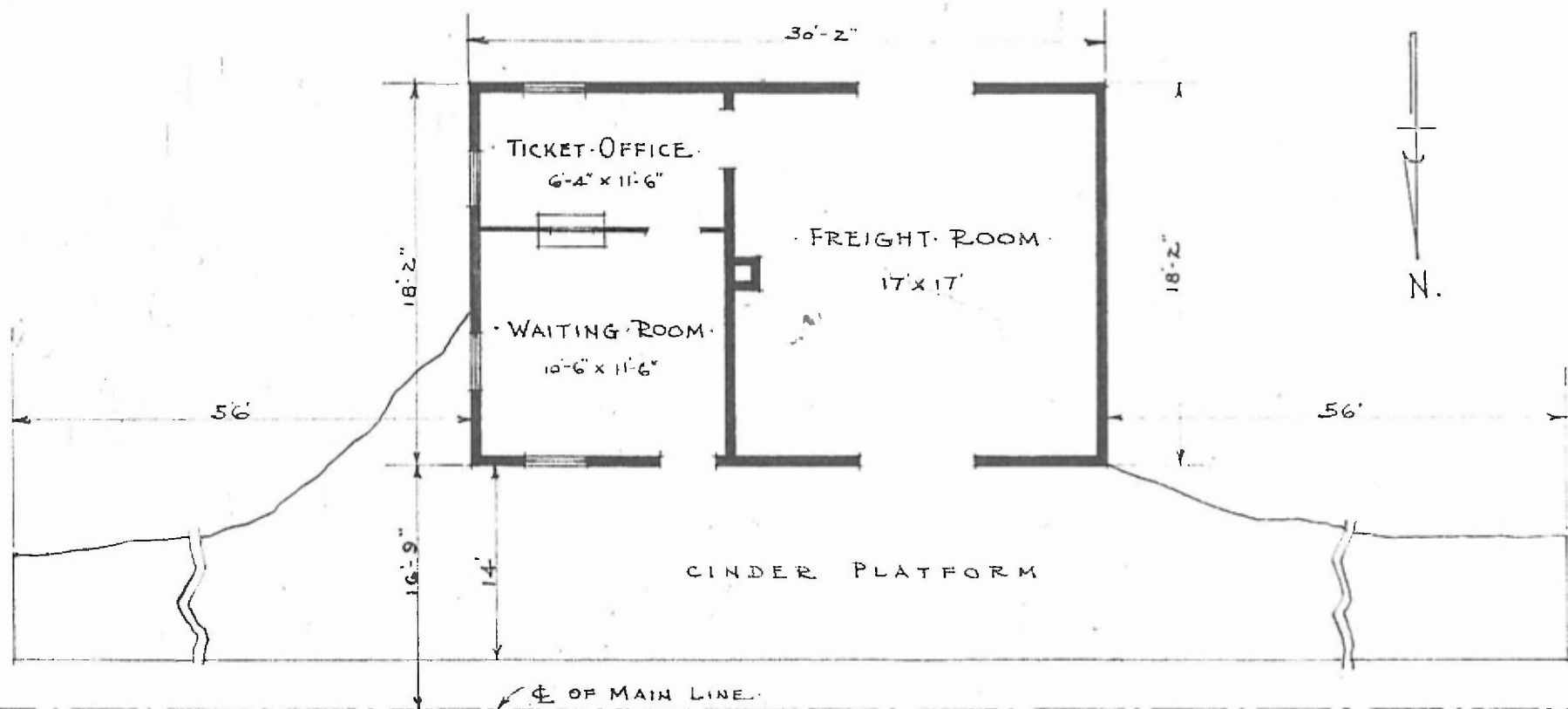

FLOOR PLAN

SCALE: 1/8" = 1'-0"

PASSENGER STATION AT
 CRESTLINE, KAN.