

·ERECTED· 1887
 ·TYPE· FRAME
 ·FOUNDATION· PILE HEADS
 ·WALLS· 2"x6"
 ·ROOF· { TYPE GABLE, SHINGLES.
 PITCH 3/8
 ·HEATING· STOVES

·FLOOR· 3/4"x3 1/4" Y.P.
 ·FINISH· { INSIDE 3/4"x3 1/4" M.&B.
 OUTSIDE
 ·CEILING HEIGHT· 14'-10"
 ·LIGHTING· OIL LAMPS
 ·SANITARY FACILITIES· OUTSIDE TOILET.

DIV. NORTHERN
 SUB-DIV. BURTON

107

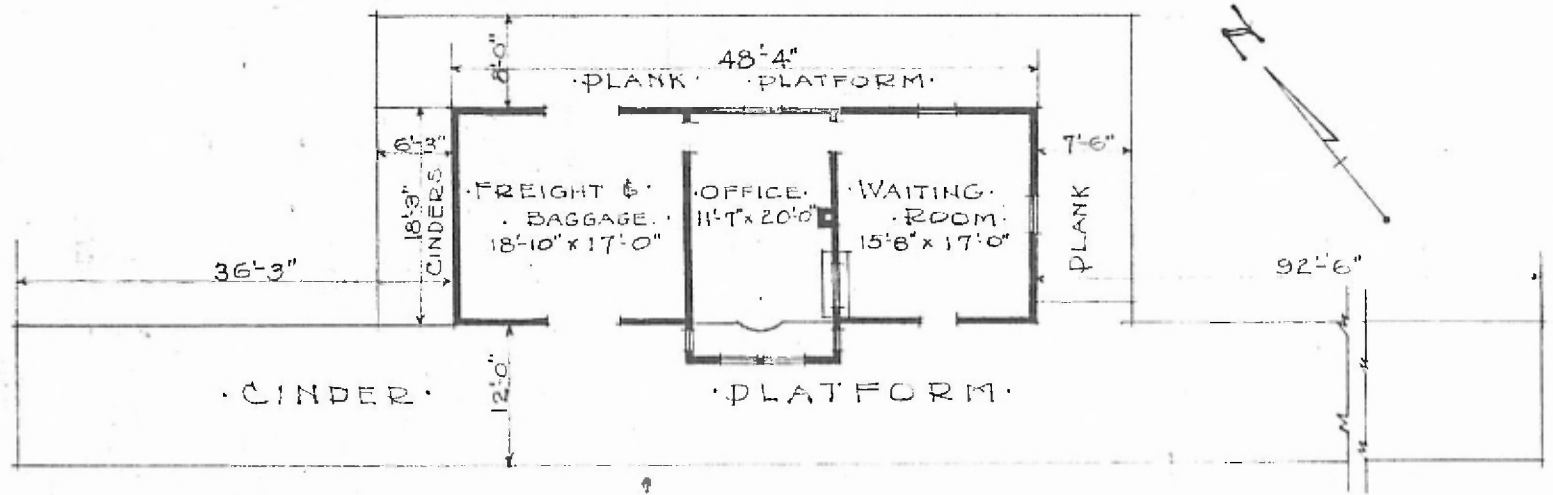

·FLOOR PLAN·
 SCALE 1/16" = 1'-0"

·COMBINATION STATION·
 ·BUHLER KANS.

APRIL 26, 1917.