

- ERECTED. 1883.
- TYPE. FRAME.
- FOUNDATION. PILE HEADS & BLOCKS.
- WALLS. 2" x 6" STUDS.
- ROOF. TYPE. GABLE - SHINGLES.
 PITCH. APPROX. 1/2 PITCH.
- HEATING. STOVES.
- FLOOR. 7/8" x 3 1/2" YELLOW PINE.
- FINISH. INSIDE. 7/8" x 3 1/2" MATCHED & E. BEADED.
 OUTSIDE. BOARDS & BATTENS.
- CEILING HEIGHTS. 11'-11" WAITING RMS. T.O.; - 12'-0" FREIGHT RM. (OPEN)
- LIGHTING. OIL LAMPS.
- SANITARY FACILITIES. OUTSIDE TOILETS.

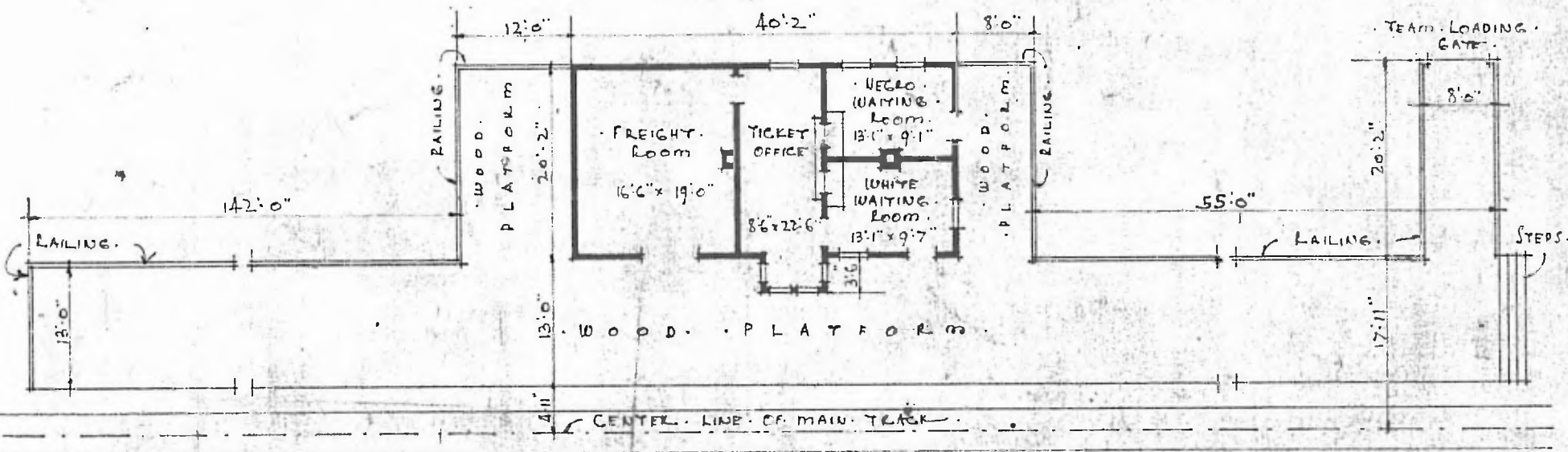

FLOOR PLAN
 SCALE - 1/16" = 1'-0"

COMBINATION STATION AT
 TYRONZA - ARKANSAS



AUGUST
 3-1917.