

ERECTED 1902

TYPE FRAME

FOUNDATION PILE HEAD &

WALLS 1x6" STUDS

ROOF TYPE 4 GABLES

SHINGLE - 1/4 PITCH

HEATING STOVES

FLOOR 7/8" x 3 1/2" Y.P.

FINISH INSIDE 7/8" x 3 1/2" CEILING

OUTSIDE 1/8" x 5 1/4" DROPSIDING

CEILING HEIGHTS - 11'-3" W.R.M.S.

T.O. = 11'-4" FRT. RM. (OPEN)

LIGHTING OIL LAMPS

SAN. FAC. OUTSIDE TOILETS  
70'-0"

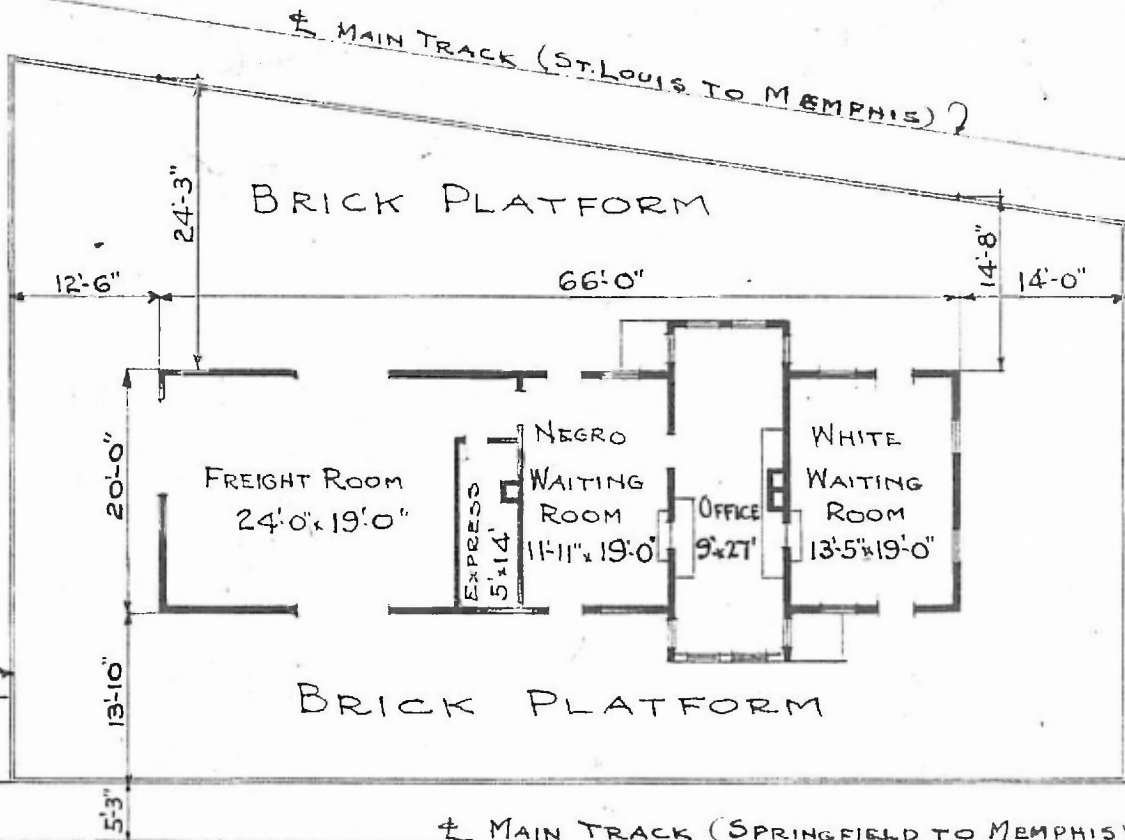
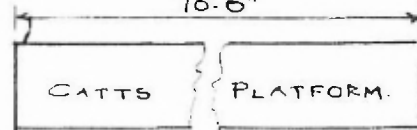

FLOOR PLAN

SCALE - 1/16" = 1'-0"



COMBINATION STATION  
TURRELL, ARK.