

ERECTED 1920.  
 TYPE TILE & BRICK  
 FOUNDATION CONCRETE  
 WALLS 8"  
 ROOF TYPE TILE & CONCRETE  
 PITCH FLAT  
 HEATING STEAM

FLOOR FINISH } INSIDE  
 } OUTSIDE  
 CEILING HEIGHT  
 LIGHTING  
 SANITARY FACILITIES

CEMENT PLASTER  
 STUCCO. 12'-0"  
 ELECTRIC  
 INSIDE TOILETS.

DIV. RIVER  
 SUB. CHAFFEE  
 STA. No. T-254

45

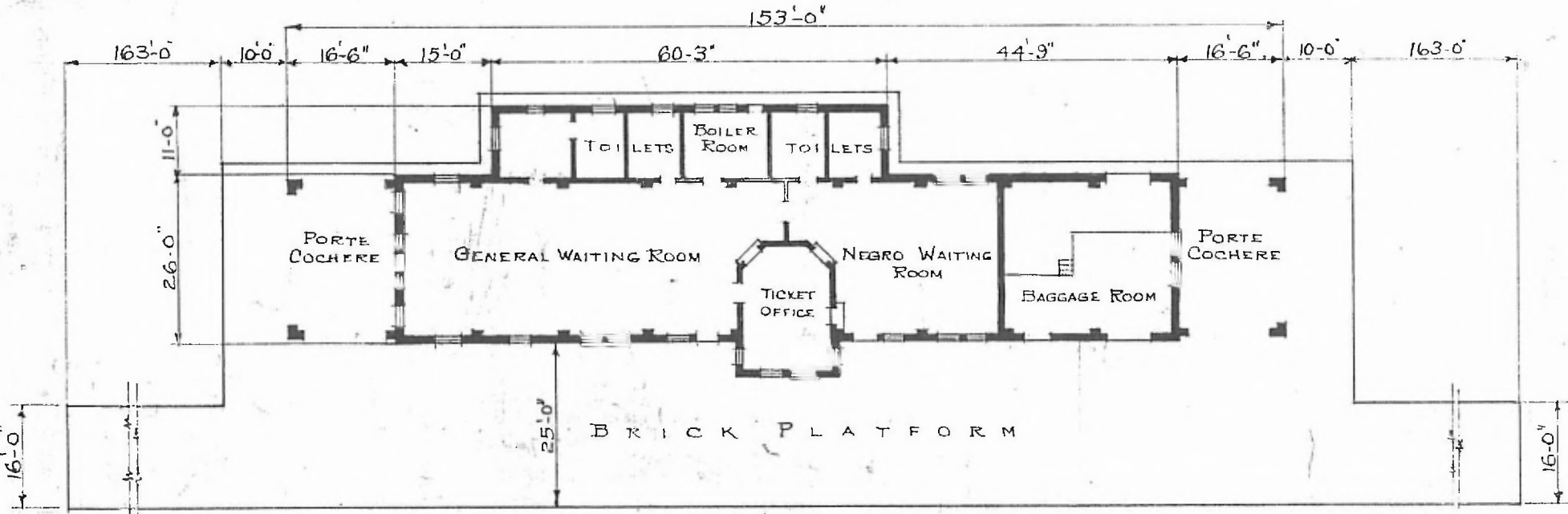

FLOOR PLAN  
 SCALE 1" = 24'-0"

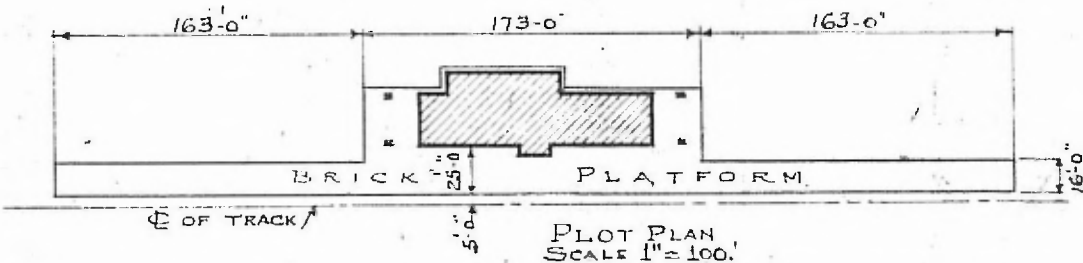

PLOT PLAN  
 SCALE 1" = 100'

COMBINATION STATION  
 OSCEOLA, ARK.