

ERECTED. 1902.
 TYPE. FRAME.
 FOUNDATION. PILE HEADS.
 WALLS. 2"x6"
 ROOF { TYPE. GABLE. SHINGLE.
 PITCH. 1/3
 HEATING. STOVES.

FLOOR. 3/4" Y. PINE.
 FINISH { INSIDE. 3/4" 3D. CEILING.
 OUTSIDE. BOARD & BATT.
 CEILING HEIGHT. 12'0" FT. 13'3"
 LIGHTING. LAMPS.
 SANITARY FACILITIES. OUTSIDE TOILETS.

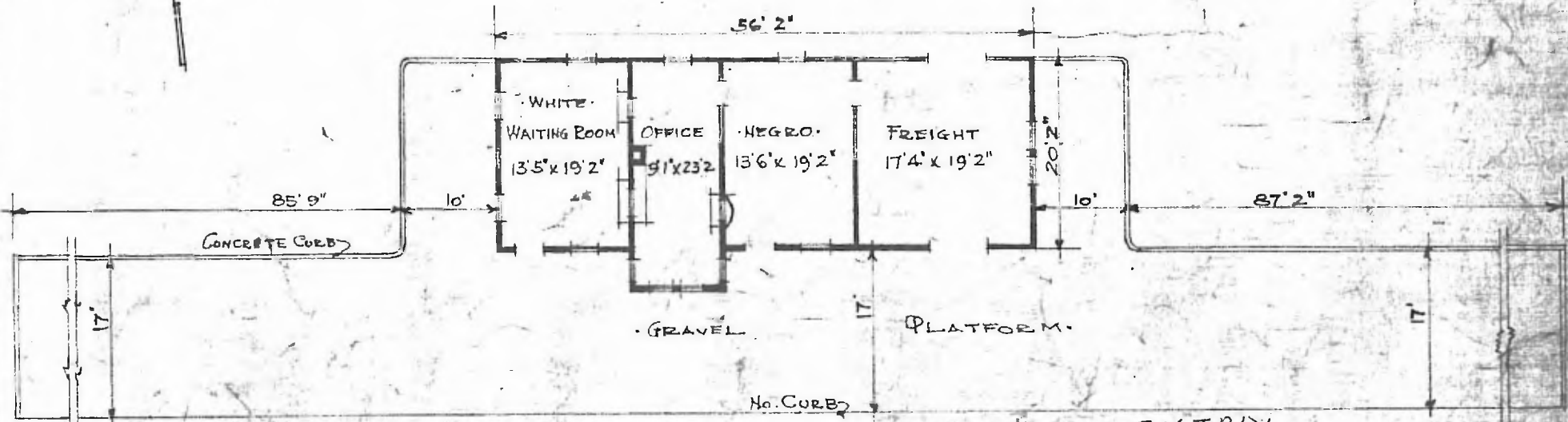

FLOOR PLAN
 SCALE 1/16" = 1'0"

DIV. CENTRAL
 SUB. DIV. ARKIN DIA
 STA NO. W. 665

COMBINATION STATION AT
 McNab Ark.

JULY 7 1915