

32.

ERECTED - 1882.

TYPE - FRAME.

FOUNDATION - PILES, BLOCKS

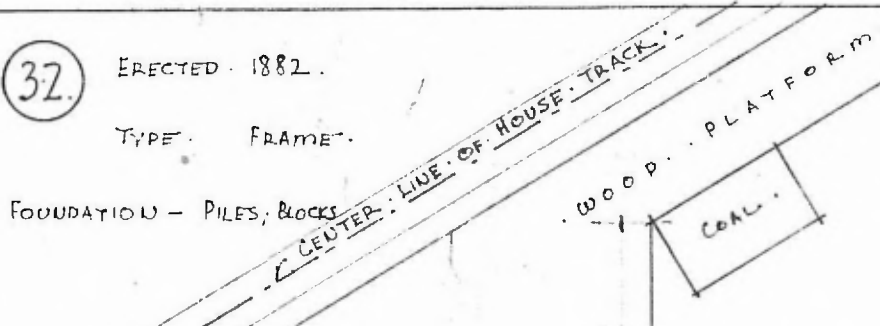

- WALLS. 2" x 6" STUDS.
- ROOF. TYPE - GABLE - SHINGLES.
- PITCH - APPROX. 1/4 PITCH.
- INSIDE - 7/8" x 3/4" m. e. b.
- FINISH. OUTSIDE - BOARDS & BATTIS - DROP SIDING.
- FLOOR. 7/8" x 3/4" YELLOW PINE.

DIV. SOUTHERN
 SUB. MEMPHIS
 STA. No C-447

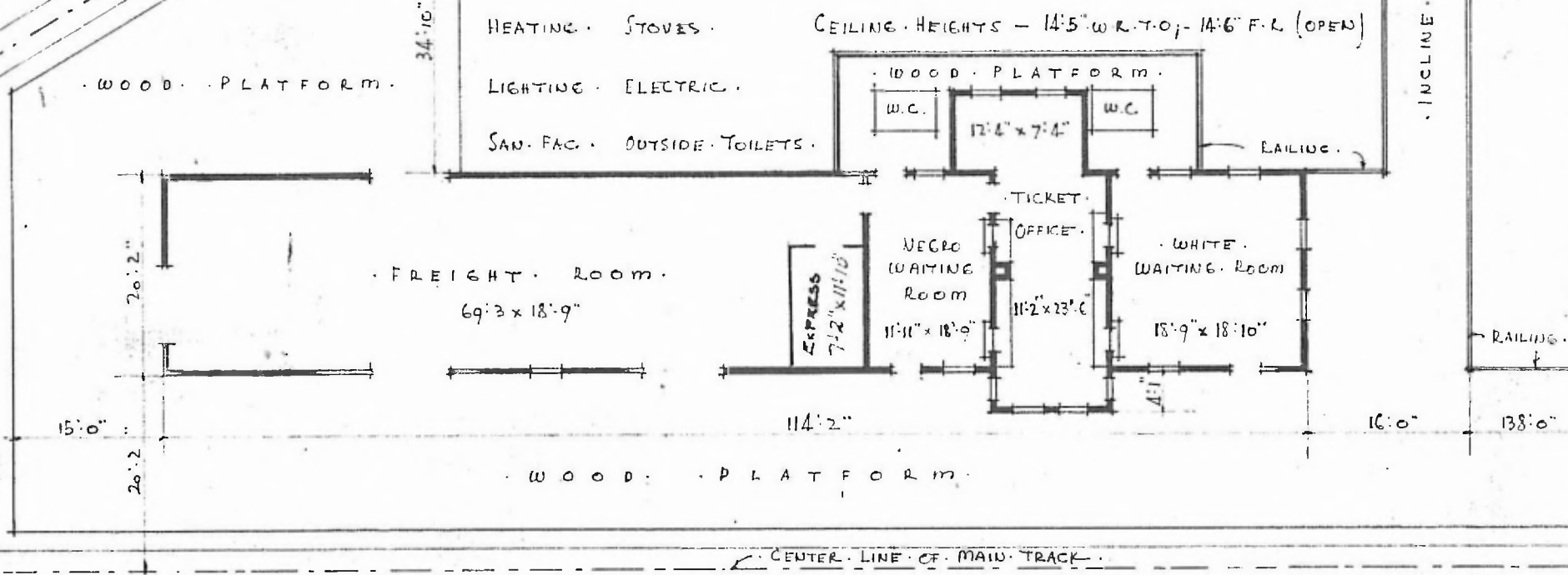

INCLINE TO STREET.

- FLOOR PLAN -
 SCALE: 1/16" = 1'0"

- COMBINATION - STATION - AT -
 - MARKED - TREE - ARKANSAS -

