

ERECTED: 1906  
 TYPE: FRAME.  
 FOUNDATION: CONCRETE.  
 WALLS: 2"x6"

ROOF: TYPE: HIP & GABLE, TIN SHINGLES  
 PITCH: 3/8  
 HEATING: STOVES  
 FLOOR: 7/8"x3/4" Y.P.  
 FINISH: (INSIDE: PLASTER, OUTSIDE: DROP SIDING)  
 CEILING HEIGHT: 10'-10"  
 LIGHTING: ELECTRIC  
 SANITARY FACILITIES: OUTSIDE TOILETS.

DIV. SOUTHERN  
 SOB MEMPHIS  
 STA. NO. C 398

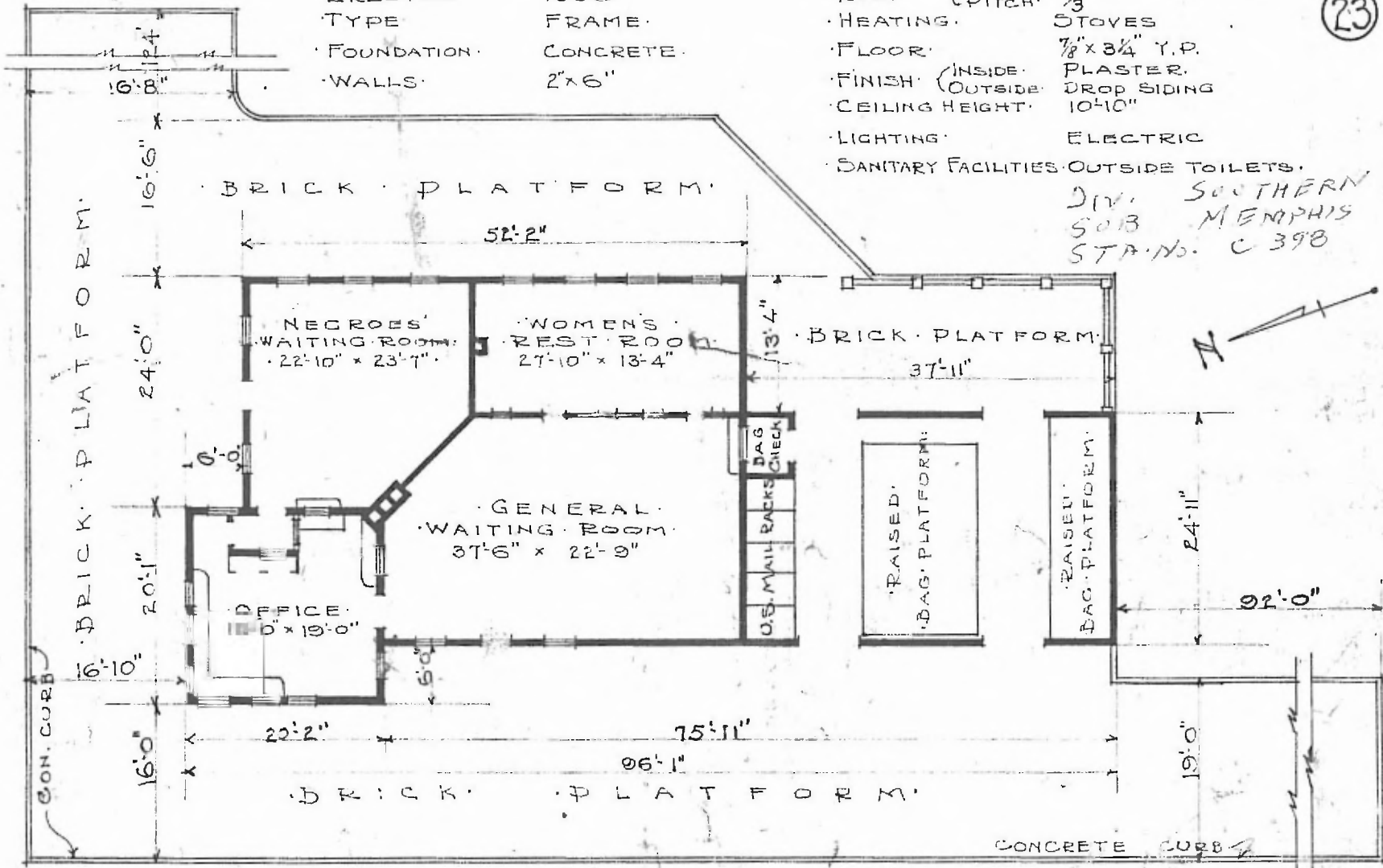

FLOOR PLAN.  
 SCALE 1/16" = 1'-0"

PASSENGER STATION.  
 HOXIE ARK.

AUG. 20, 1917.